

February 2026

FREE monthly community magazine for Kumeu
& surrounding townships

Kumeu

Courier

- 
- Safer communities
 - Home & garden
 - Health & beauty
 - Property market report

**Chris Penk- MP for
Kaipara ki Mahurangi**



Greetings

It's hot!

January brought a melt-down and February looks similar.

A cool southerly wind helps but when that goes, the heat rises.

Sleeping has been a mission with the warm nights and I start to long for cooler nights again.

Perhaps it's age but I sleep better in winter.

I know it's the age when people I've dealt with over the years depart this earthly life.

During the latter part of last year and earlier this year they included former Waitemata City Mayor Sir Tim Shadbolt, Waimauku's Ross Kerr-Taylor, cyclist mate David Papa who I last featured in the Kumeu Courier when his mum Mary turned 100 in 2022 (she'll be 104 soon), and ex-Haines Haulage house mover Brian Lawton. More on some of these inside this issue.

So I'm left with many memories of the people and places around the area, now heavily changed as more people come here to live.

State Highway 16 to Waimauku has finally been improved but traffic congestion is still a major factor, especially to the east of Kumeu.

I wonder if the long-awaited City Rail Link will improve things - and we get passenger trains to Huapai and Helensville as well.

I thought our cost-of-living was going to dive when the official cash rate (OCR) dropped to 2.25%. Now I hear of vehicle registration increases (from January 1), rate rises, some food increases and the larger banks predicting many mortgage rates will rise again from mid-2026.

Just when I thought the end of it all was in sight.

The next OCR and monetary policy statement is on February 18 this year.

Many economists forecast little change and that house prices might rise again this year but only by about 2% or up to 6%.

They also expect continuing affordability issues, modest growth, better housing supply and some easing of credit.

So this year holds more promise than the last - barring wars, pandemics, Donald Trump's sagas, and other issues.

Editor , Geoff Dobson



Circulation is 10,000 print copies. Advertising starts at only \$100 + gst which includes a business card, editorial and an image. Get in touch with Gabrielle today editorial@kumeucourier.co.nz

ENQUIRIES / FEEDBACK / ADVERTISING:
Geoff Dobson
P 027 757 8251
E geoffdobson2017@gmail.com
W www.kumeucourier.co.nz

COVER PHOTO: Chris Penk MP
PRINT RUN: 10,000 copies, Treehouse Print
EMAIL DATABASE: Sublime NZ

DISCLAIMER: Articles published are submitted by individual entities and should not be taken as reflecting the editorial views of this magazine or the publishers of The Kumeu Courier Limited. Articles are not to be re-published unless written consent is granted from the publisher (Graham McIntyre).

What's inside

- 3 People & Places
- 9 Safer Communities
- 10 Community News
- 16 Food & Beverage
- 17 Property Hub
- 19 Property News
- 24 Property Statistics
- 28 Property Market
- 41 Home & Garden
- 49 Young Learners
- 51 Aged Care
- 54 Health & Beauty
- 57 Area Columnists



People & Places

2026 is the Year!

I'm delighted to share with you that I strongly expect that 2026 will be the most significant year for infrastructure in northwest Auckland in decades. I thought it would be timely to run through some of the major issues that I've been working on - as your local MP, in close contact with the current government - in this edition of the Kumeu Courier.

While it would be easy to focus on the past, bemoaning decisions that led to a lack of infrastructure delivery, more useful will be an explanation of the way ahead. I will point out, however, that I see one of my key roles as advocating to authorities that we don't repeat the errors of the past.

Into this category falls the issue of planning residential development in floodprone areas. And of course we also need to be mindful of the effects of the industrial and commercial built environment, along with roads and railway lines, on stormwater flows.

Auckland Council has taken an enlightened view on this issue since the major flooding events of 2023 and I'll continue to support them in that. Locals will also recall the huge flooding of August 2021 and surely share my view that we can't allow any more developments that don't at least "wash their own face" in terms of systems that shift large volumes of stormwater away from Kumeu and surrounding areas.

And now let's catch up on the key items needed as we play catch up on many years of a lack of planning and infrastructure delivery:

An additional High School

Other than transport-related issues, the need for an additional high school in northwest Auckland is probably the single issue most often raised with me. It's simply a numbers game, with massive population growth and the addition of primary school classrooms (and a whole new primary school in the case of Matua Ngaru). I have been asking the Ministry of Education to take this issue seriously since I became the MP for this area and spoken publicly, in Parliament and in the media about it too.

I'm delighted that the Minister of Education, my colleague and friend Erica Stanford, has been taking a close interest in the matter. We discuss it often. Once we (finally!) have the necessary parcel of land secured, the remainder of the new school logistics should be relatively quick.

KUMEUCOURIER.CO.NZ

These days it's possible to use modern methods of construction to get classrooms and the other necessary buildings onto new school sites very quickly. The most likely timing for a significant announcement about what's happening here is next month.

SH16 works

After years of good intentions to widen SH16 to allow extra lanes between Brigham Creek and Kumeu / Huapai, this crucial project has now finally been funded. Plans to do the widening work and place a roundabout at the intersection of SH16 with Coatesville-Riverhead Highway have existed for years. Most importantly, though, the project has recently been given priority in the form of the necessary funding to actually make it happen.

Without dwelling unduly on the past, I'll point out that it's been hugely disappointing that this important project wasn't completed on its original timeline (completion by the end of 2021!) and it will be important that we don't lose momentum once the works begin. These will inevitably be disruptive so patience will be needed, as well as a good plan to minimise delays and promote alternate routes.

I will be advocating for careful measures to ensure that we don't have an unnecessarily high usage of road cones and stop/go signs making life harder than it needs to be. And that the works happen quickly once underway.

Kumeu Bypass

The real game changer will be the Kumeu Bypass, however. Again it's something that's been talked about for many years. And again we now finally have tangible progress.

Officially named the "Alternative State Highway 16", the route is well known and affected property owners are aware of these intentions. The tangible progress of the past year or so has been inclusion of the Kumeu Bypass in the government's suite of "Roads of National

Chris Penk

MP for Kaipara ki Mahurangi

Here to help

134 Main Road, Huapai • christopherpenk@parliament.govt.nz • 09 412 2496

National
Authorised by Chris Penk, 134 Main Road, Huapai.

Significance”. This gives the project a status of priority when it comes to ensuring as quick a passage as possible.

Naturally we need to be mindful of the rights of residents and business owners whose land will be acquired for the road. A fair process to negotiate and compensate for the land needs to take place for constituents. It’s my role as local MP to support that as needed, along with the overarching desire of the community to de-congest our roads.

Northwest Express Busway

It’s also been a priority for me to help provide public transport solutions for the area, acknowledging that selecting bus routes on our current roads is the responsibility of local government (think Auckland Transport with input from the Rodney Local Board). A dedicated, separated northwest busway is under construction at Westgate now ... with arrangements being made to provide a connecting transport solution for residents of Kumeu and surrounding areas. This will help congestion on SH16 hugely, just as the popular and well-patronised northern express busway on the north shore has relieved pressure on the Harbour Bridge significantly.

I was delighted to join the Transport Minister, being my colleague and friend Chris Bishop, and Mayor Wayne Brown for the official “sod turning” ceremony to mark it getting underway last year. While full completion of this project will take some time, the “staged approach” being taken will ensure some benefits in terms of congestion and travel time will be realised in the short term.

Here I should note that, while I pushed for a long time for passenger rail to be made available to extend the current (double-tracked, electrified) western line that ends at Swanson, the new dedicated busway should make a positive difference in much the same way as a train service would have.

Kumeu Show

Finally, I will just add that there are many great community events planned for our area this year. Not strictly infrastructure-related (and in fact the roads around the Kumeu Showgrounds are sure to get even worse on event weekends) but important to note for the health and heart of the community. Please be sure to come and have a chat at my local MP stand at the Kumeu Show in just over a month. I began by sharing my expectation and hope that 2026 will be the most significant year for infrastructure in northwest Auckland in decades. I certainly will be working hard, as your local MP, to ensure that we get significant progress on all these projects. And I’ll keep you posted with regular updates on it all.

For now, take care and I look forward to seeing you out there.

Chris Penk MP for Kaipara ki Mahurangi

O’Black Cosmetics: Skincare Inspired by NZ Nature



You’re probably thinking it’s just another skincare brand. And honestly, that’s fair. Skincare is a busy space, full of promises: youth, glow, endless routines, miracle results. Science has taken us far, from ancient knowledge of healing flowers and oils to today’s understanding of active molecules and advanced formulations. But skincare isn’t about chasing trends or filling shelves. It keeps evolving because every skin is different and

deserves care that truly fits.

That’s where O’Black Cosmetics comes in.

I’m Andreja, the chemist behind O’Black. My background is in pharmaceutical manufacturing, but I was always drawn to the healing side of nature. Late at night, after work, I found myself experimenting in my kitchen, making balms, creams, peels, even shampoos. I kept asking myself: why do so many products rely on unnecessary thickeners and synthetic fillers, when we could create rich, gentle formulas focused on what really matters? I wanted to offer skincare built around quality ingredients – or as I explain at my workshops: active ingredients. Vitamins, humectants, and botanical extracts that allow for a simpler routine that still delivers results. Fewer steps, more nourishment.

New Zealand has deeply inspired my formulations. You’ll find organic NZ beeswax in my Lip Balms, NZ sea salt in the Lavender Relax Bath Salts, and very soon, Mamaku Dewlight Face Cream featuring black fern extract, NZ green tea, and niacinamide for deep hydration and a natural dewy glow. The range stays intentionally simple: face creams for sensitive or tired skin, face oils, lip care, bath salts, thoughtful gift sets and few more.

For me, O’Black isn’t just a business. It’s about sharing knowledge, building confidence in your skin, and creating products I genuinely love. You’ll often find me at local markets with samples and a friendly chat. Come say hello, I’d love to meet you.



People & Places

Lovesoul beauty & spa studio



Welcome to the New Year at lovesoul beauty & spa studio As the pace of summer begins to soften and we settle back into routine, February feels like a natural moment to pause, reset, and gently turn our attention back to ourselves.

At lovesoul beauty & spa studio, we’ve reopened for the year feeling refreshed and grateful to be welcoming familiar faces – and new ones – back through our doors. The new year isn’t about rushing into change; it’s about easing back into balance, nourishment, and care, in a way that feels supportive and sustainable. We offer a thoughtfully curated range of holistic beauty and wellbeing treatments, including nurturing facials using Janesce botanical skincare, deeply relaxing massage, waxing, brow and lash services, and small ritual moments designed to help you slow down and reconnect. Whether you’re seeking relaxation, skin support, or simply a quiet hour to yourself, our treatments are tailored with intention and care.

February is also a wonderful time to focus on skin health after the warmer months – restoring hydration, calming sensitivity, and supporting your skin as it transitions into the new season ahead. Our team is always happy to guide you toward treatments and products that suit your individual needs.



Thank you for continuing to support our small local business. We look forward to another year of caring for our community and creating space for rest, renewal, and wellbeing

Kumeu floods book out

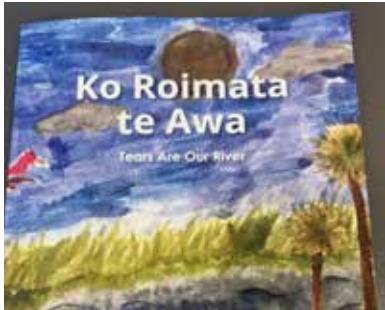

‘Ko Roimata te Awa/ Tears Are Our River’ is a collection of stories by Matua Ngaru School students, sharing experiences, memories and the resilience of the Kumeu community following the 2023 floods.

The 42-page book was launched at Kumeu’s Matua Ngaru School late last year. “Our young authors and illustrators worked all year alongside author David Riley through his Reading Warrior project, inspiring our tamariki to see themselves as authors and storytellers,” says Matua Ngaru School Deputy Principal Ann Marie Dunne.

“The illustrators worked with Holly Manning, a local artist to produce the beautiful water paint art.

“A massive thank you to Andie Davies from the Kumeu Baptist Church for connecting us all together and starting this amazing project.”

Ko Roimata te Awa is available within the Kumeu community and shared nationally and internationally. The Auckland Council includes the book in its nationwide Recovery Newsletter and Ou rAuckland publication. Visit ko-roimata-te-awa.pdf for more information.

“They will include Sad Stories by Lydia Butterfield in their official Recovery Story report for Tāmaki Makaurau and this will be shared internationally,” Anne Marie says. “What an amazing achievement!

“Ngāmihinuitoeveryonewhcontributedtothisincredible taonga and our incredible authors and illustrators.” Ko Roimata te Awa/Tears are Our River is written and illustrated by Emily Blackmore, Lydia Butterfield, Mervyn Cooksley, Mila Davies, Felicity Ebenezer, Ethan Edwards, Zoe Gates, Millie Glennie, Josh Henderson, Caleb Joseph, Sophie Lennon, Emily McClymont, Albert Niga, Maddie Page, Emily Pyzhanov, Samrita Singh, Caitlin Trinder, Isabelle Wang, Joshua Williams and Honor Yavunisautu with David Riley and Holly Manning.

In the introduction by Caleb Jospeh he says: “We wrote this book so that people in our community will know what to do if the river floods. This will help people to be safe, and we will be happy to know that we have helped so many people.” Many of these children have themselves experienced flooding in our community and it was very brave of them to reflect on these times, and those of others in our community, to write and illustrate this book, says Kumeu Baptist Church Co-Pastor Andie Davies.

“The voices of tamariki are often silent during emergencies as adults make decisions on their behalf

but not always with them in consideration.

“This book is an opportunity for their voices to be heard – their perspectives, their sadness and their joy related to the stories of Kumeū River.” loods have been recorded in Kumeu seven times since 1928, according to the book which says one in 1954 was on Kumeu Show day.

“...the river rose so high that all the shops in Kumeu were flooded. The water was so strong it washed a car off the road at Huapai and into the raging water.”

The book says that in 2023 the river flooded five times in four months. Main causes are listed as rubbish and debris from construction sites and “dead trees that fall into the river and act like a giant plug, trees that would slow the water’s flow have been chopped down and replaced by roads that speed the water up” while Kumeū township is built on a flood plain, the book says.

It notes climate change is also having an effect.

Franklin cup won by Kidz Kartz Kumeu teen

Kidz Kartz Kumeu driver Karli MacPherson drove a perfect race with pony Kookies N Kreem to win the 400 metres Franklin Pony Cup on Friday December 12, 2025, at Auckland harness racing venue Alexandra Park in Epsom. Karli (sponsored by the Caduceus Club) was on the back marker, says Deneece Goldsworthy of Kidz Kartz Kumeu.

“Her handicap was 460m so she had a lot of work to do to make up the difference. “Pony Kookies N Kreem did a perfect standing start and soon ate up the extra handicap to work past the other ponies to win by about 30m with family and friends cheering her on from the sideline. It was an exciting evening for all.”

Karli joined Kidz Kartz this season at the start of the club year in early September 2025 Because Karli was already over the 10-year starting age to drive at another track (she is 13) she first had to learn to drive, gear up and do many horsemanship skills to pass the driving licence.

“A lot of work on her part got her through and already having some horse skills helped her<” says Deneece. Tom Knight, also from Kidz Kartz Kumeu, won the best presented in the Bird Cage on Starstruck.

Email kidzkartzkumeu@gmail.com for more information or check their Facebook page Kidz Kartz. photo credit: Photos Photoforce



New Northwest cemetery

The Auckland Council is buying 6.5 hectares beside an existing private cemetery in Kumeu as a future site for cemetery operations to serve the growing Northwest communities. The site to be developed over the coming years is at 870 Waitākere Road near Kumeu.

This purchase follows the council’s ongoing search for suitable cemetery land as some cemeteries approach burial capacity. The property has been selected for its location and physical characteristics and will augment Auckland’s extensive cemetery network.

So says Auckland Council General Manager for Parks and Community Facilities Taryn Crewe who is pleased to secure this important purchase ahead of final settlement in March this year. “Our cemeteries provide such an important service, and this new site for northwest Auckland, beside an existing cemetery, will cater for the needs of this community for many years to come,” says Taryn.

Rodney Local Board Chair Guy Wishart is delighted. “This is extremely pleasing for our local board and the people of Rodney – we look forward to working closely with all our stakeholders including mana whenua on the design for this site.”. The council has been in contact with Te Kawerau ā Maki and Ngā Maunga Whakahii in this process and it will do wider stakeholder liaison through the consenting and design phases for the site. Planning toward the future use of the Kumeu site will begin early this year.

The Auckland Council’s cemetery network is extensive, owning and operating 53 cemeteries across the region, covering about 300 hectares. There are three main large cemeteries called “hub cemeteries” – Manukau Memorial Gardens, North Shore Memorial Park and Waikumete Cemetery. The three hub cemeteries are among the 30 operational cemeteries across the region and are also home to the three council-operated crematoria.

About 80% of council-administered burials in the region are held across the three hub cemeteries. The other burials are delivered across the 27 other cemeteries. Each year the Auckland Council does about 1500 burials, 1000 ash burials and 2400 cremations, hosting around 800 chapel services and 450 lounge hires. About 40 staff are based across these three sites, including customer service representatives, sextons and managers.



What’s the greatest compliment? When care is felt

For many, the thought of having a colonoscopy or gastroscopy can be a time of anxiety and uncertainty, which is why choosing a trusted provider is essential to ensure a safe and comfortable experience. At Waitematā Endoscopy, genuine patient experience is the most meaningful feedback and powerful form of endorsement. We deeply value the trust patients and referrers place in us during these vulnerable moments, and authentic feedback reminds us of the responsibility we carry and how care is felt.

As expressed by a few of our recent patients who have shared the following: “From the very minute I walked in I was so impressed with how friendly and helpful all the staff were. They went above and beyond and I loved the little touches like putting on a heater for me and lots of smiles and great instructions. My Doctor John Perry was very good and informative and I felt I had a very professional procedure to the highest standard. All the nurses were so friendly and helpful and I had the best experience. Thank you for your hard work and I really appreciated it all.”

“I know it sounds very strange to say you had a positive experience having a colonoscopy but that is how the staff here make you feel. From the time I walked through the door everyone was so kind and caring. From the

receptionist to the nurses, and the lovely Dr Pandey, everyone was very professional and everything was well organised. Lovely touch at the end when I was having my sandwich and coffee and they brought my friend who had come to pick me up, to sit with me. They sent me home with a full report and lots of helpful literature to provide more information. They managed to make something that is inherently very stressful into a very calm and positive day. Thank you.”

“What a great experience from the team – fully prepped for my colonoscopy (yikes!) I turned up early – a day early it turns out – I was met without judgement and with incredible kindness and they fitted me in without it feeling like they were – 6 star service when it was my responsibility for mixing up the days – so grateful.”

These speak to our level of clinical excellence and affirm that our purpose, to provide exceptional endoscopy care at every opportunity, matters. With a commitment to continuous quality improvement, we also regularly survey our patient’s experiences, and are delighted that in our most recent results, over 99% said they would recommend us to a family member or friend needing an endoscopy.

At Waitematā Endoscopy, we aim to make taking a proactive approach to your health easier. Our experienced team will help to put you at ease when it comes to your endoscopy. Take a virtual tour of the patient journey and our clinic for an insight of what to expect at www.waitemataendoscopy.co.nz/locations

Noho ora mai (Stay well) Sarah McNamara. Quality Coordinator & Endoscopy Nurse. Waitemata Endoscopy

WE

are dedicated to exceptional patient care

With increased capacity, Waitemata Endoscopy is able to offer timelier access to a group of experienced Gastroenterologists and Surgeons.

Appointments are available **within 7 working days** for most Colonoscopy & Gastroscopy procedures by matching you with the availability of our experienced Specialists*

Talk to your GP about a referral to the Waitemata Endoscopy Group, or you can self-refer at:

www.waitemataendoscopy.co.nz/referrals

WE have you covered from 'Top to Bottom'

*Scan to find out more or call us on (09) 925 4449

Kia ora Kumeu and Nor-west community

I'm Kyra Shaw-Toomey, your Community Facilitator for the Rodney Community Team in your area. This is a new community initiative funded by the Rodney Local Board.

Having lived and worked in the North West for the last decade, I am passionate about enhancing our community for our children, young people and everyone else as well as preserving our beautiful area. I'm currently living in Bethells Beach, South Head. I'm excited to support my community and bring new activities, programmes and events to the wider Kumeu area. Our new Community Team is working in Rodney to create opportunities and spaces for the community to come together and build a better future.

If you have an idea, initiative, or event to bring to our community, I'm available to support groups, businesses, and community members. Our focus is on connecting neighbours, fostering play and creativity, and improving our shared community spaces.

Starting in February, you can drop in at the Kumeu Library on Wednesdays between 9am and 12pm to chat. Please bring your ideas and aspirations for our community and the spaces we all enjoy.

Contact details:
Kyra Shaw-Toomey
Phone: 022 589 3804
Email: kyra@rodneycommunity.org.nz

FRANKLIN FARM 1906 Waimauku

Sunflower Fields Butterfly House Animal Farmyard & more!

stay up to date - Franklin Farm Waimauku franklinfarm.nz

Opening late December



Pet patch



100% NZ owned and operated Pet Shop located in Huapai, Auckland where you will find everything you need to enrich the lives of your furry, feathered and scaly friends.

Our Story

Our love and passion for all things pets has led us to open our very own pet store with a difference! We stock top quality products with the aim to enrich your best friends lives nutritionally, physically and mentally. We come with years of knowledge and experience and are always looking to find new and exciting products for you and your family!

Shop and Save

Earn Loyalty dollars to spend in store

when you sign up to our 'Part of the Patch' loyalty program and shop with us!

*T & C Apply <https://petpatch.co.nz/products/>

PET PATCH

Your Local Pet Store

1 Shamrock Drive Kumeu

09 412 2009

www.petpatch.co.nz



Safer Community

Flooding, Slips and Subsidence



Fire and Emergency deploys to a wide diversity of incidents around the country to protect people and what they value. The recent water deluge that dropped on Oakura is similar to the saturation that occurred through Piha and suburbs in August 2021, Auckland in January 2023 and Muriwai in February 2023.

When soils become over-saturated and the soil layers create a Laha layer, the resulting damage is significant and occurs almost instantaneously affecting large areas of land.

In most instances before the land releases you will get the following signals:

- Significant soil filled water with large water volume and pressure
- The land may start to slump in places or seems to put weight on solid objects like trees, posts, structures, retaining walls.
- These hard objects may resist for a small time but not a long time as the weight transfers
- Sudden release will ultimately occur bringing plant matter, mud, dirt, water, trees, poles all cascading down until it is held back by geography or hard objects (then may repeat)

The level of public understanding in slips and subsidence is limited and until recently Fire and Emergency had no



training module available to paid and volunteer staff. The tragic loss of Craig Stevens and David van Zwanenberg in Muriwai on 13th February 2023 highlights the extreme risks that exist. David and Craig were both excellent Fire Fighters at an experienced level and other observers at the site had no significant pre-warning.

What did exist was the significant soil filled water which presented in volume and under pressure. While in Muriwai's Domain Crescent that night, my team door knocked a number of houses to ensure the occupants had evacuated as the hillside moved. One house I went to had the same significant soil filled with water of volume and pressure gushing out of the back door and onto the deck. We knocked on the door and the owner answered, he was completely unaware of the deluge at his back door, unaware of the failing hillside and oblivious to the immediate danger that existed to him and his wife.

Please be aware of the warning signs. Please act quickly to get your loved ones out of harm's way. For any information on this article or related Fire and Emergency information please get in touch-

Contact

Call Graham McIntyre, Phone 0276 320 421 or email graham.mcintyre@fireandemergency.nz

Graham McIntyre
Chief Fire Officer -
Waitakere Fire Brigade



Community News

ABIS – Accredited Building Inspection Services



ABIS is a trusted, independent building inspection company based in Auckland, providing thorough and reliable property inspections for homeowners, buyers, and sellers. Led by Jozef, an LBP and BOINZ trained Building Inspection Surveyor, ABIS is committed to helping clients make informed property decisions with confidence.

With over 30 years of experience in the building industry, ABIS has

an extensive understanding on how New Zealand homes are built, and how they can fail over time. Our inspections are carried out using a careful, methodical approach and in accordance with NZS 4306:2005. From older villas to modern builds, we inspect each property with the same attention to detail and professional care.

ABIS provides comprehensive pre-purchase and pre-sale building inspections, healthy homes compliance inspections, weathertightness and moisture assessments, maintenance inspections and more. Reports are clear, easy to understand and include photographs of any areas of concern, allowing clients to clearly see and understand the condition of the property.

What sets ABIS apart is our commitment to independence, transparency and honest reporting. We do not carry out repair work, ensuring our advice remains unbiased and solely in the best interest of our clients. Our goal is not to alarm, but to inform and provide practical insights that help clients plan, negotiate or proceed with peace of mind.

Proudly servicing Auckland, ABIS has built a reputation for professionalism, reliability and clear communication. Whether you are purchasing your first home, selling a property, or are seeking reassurance about an existing investment, ABIS offers building inspections you can trust. For more information, visit www.abis.nz or get in touch with Jozef on 027 946 6994

Comprehensive Building Inspections You Can Trust

• Pre-Purchase • Pre-Sale • Residential Inspections

LBP & Accredited Building Inspection Surveyor

027 946 6994

www.abis.nz

Auckland

Smashing Promotions continues its incredible growth

We are proud to announce that Smashing Promotions has become an official vendor to Qantas, supplying Jetstar with custom-made tool bags.

Closer to home, Simplicity recently loved their new range of custom trucker caps and bespoke playing cards, created to reflect their brand with personality and impact.

If you are looking for a fresh and innovative promotional initiative, we love a challenge (as long as it's legal). From concept through to delivery, our experienced team works closely with clients to create practical, creative solutions that truly stand out.

Give Mark and the team a call today and let us wow you.

phone (09) 4126235

Check out the webiste at www.smashingpromotions.nz

Established 1993



SMASHING PROMOTIONS

Branding Anything Legal

Marketing that delivers Fresh ideas, real results

Tel 412 6235 – Super friendly Professional staff

SmashingPromotions.nz Est . 1993

Community News

Mindset shifts in amazing Muriwai



Now working from a stunning Muriwai location, as well as an office in Te Atatu Peninsula, I use my skills, knowledge and life experience to help you make shifts in your subconscious to create real changes in your life. What I do gets to the root cause of any issue and resolves it.

If you need help with addiction, anxiety, panic attacks, childhood emotional neglect,

confidence, eating disorders, fears, phobias, lovability, procrastination, lack of motivation, relationship issues, sexual blocks, and/or weight issues then I am the therapist for you.

If you have something you want to be free from, I give you that freedom. If you have something you want in your life and can't seem to get, I help you to get it. I help you to update the software in your mind to become your most confident & healthiest self.

Who wouldn't want to heal in this location? Check out the view from my office. Get in touch so we can chat about getting you the freedom you've always wanted.

Lorraine Maguire Therapy

www.lorrainemaguire.com

Lorraine Maguire

TRANSFORMATIONAL HYPNOTHERAPIST

I help you update the software in your mind to become your most confident & healthiest self.

021 664 384 • lorraine.maguire@xtra.co.nz
www.lorrainemaguire.com

Gareth Quarterman

Director/Owner

Metal Fabrication & Manufacturing

gareth@qmetaldesigns.co.nz

Tel: +64 21 959 719

www.qmetaldesigns.co.nz

751 Sh16, Kumeu, Auckland, 0883, NZ



HUAPAI DENTAL CENTRE

A healthy smile makes a lasting impression.
Take care of your teeth with confidence and take advantage of our **\$199 check-up, xrays and hygiene combo for new patients** for a *limited time only*.

Whether you need a check-up, need urgent care or are thinking of a smile makeover, our experienced team is here to help.

Our services include:

- General and preventive care - checkup & hygiene
- Cosmetic makeovers - veneers, crowns, whitening
- Emergency dentistry - same-day appointments for accidents & toothaches
- Sleep dentistry - IV and oral sedation available for a relaxed experience
- Dental implants, dental bridges, and dentures for tooth replacement
- Free basic dental care for high school children aged 13-17

Contact us below, or book online via our website!

250 Main Road, Kumeu 0810

022 412 7155 | huapaidental@gmail.com



www.huapaidental.co.nz

111 VET CLINIC

KUMEU

09 86 96 111

Regular & Emergency Veterinary Care

in the of Kumeu

OPEN 24 HOURS

7 days | 365 days of the year

48 Main Road, Kumeu | office@111vetclinic.co.nz

freedom

companion driving

Paul Miller

Freedom Drivers Hobsonville

+64 021 321 869 I (09) 302 2377
hobsonville@freedomdrivers.co.nz

- Hospital & Medical Appointments
- Specialist Treatments
- School Transport
- Airport Transfers
- Shopping & Social Trips

ACC Approved • Total Mobility Cards • Eftpos

Davis Funerals



This month I want to offer a personal reflection on the Christmas season just gone, not so much the weather, but instead some of the poignant moments that for me and the team at Davis Funerals underscored the value of the importance of a “farewell done right”.

Every December we host a growing number of families at our annual remembrance service and supper. An evening of laughter, yes, a few tears, connection, and reflection, involving families who have experienced the loss of a loved one in the recent past. Chatting over a cup of tea, what was evident is the immense value gained from having a farewell, the benefit to be gained taking time to reflect, and how doing so empowered those families to better manage and learn to live with the inevitable grief linked to death.

In December, Davis Funerals was the key sponsor and partner of the Mercy Hospice Lights to Remember event. One of the major annual fundraising events for the hospice. Aside of the spectacular visual, and being given

the opportunity to address those gathered, a number of comments that were offered to me as people took in the lights and listened to the talented violinist from the Auckland Philharmonia again reinforced the immense value of a farewell in helping people navigate their grief, and of course the invaluable support of the hospice to the community.

Coverage of these events can be found on the Davis Funerals Facebook page.

Throughout the holiday period I had the privilege to personally assist several families. We know that nobody wants to be dealing with a death, less so during the holiday season. In each case these were families who had had a previous experience with Davis Funerals and where I had taken care of past arrangements for them. Aside of the personal reconnection, that of course everyone involved would wish could be under happier circumstances, what was so apparent was the immense burden that was lifted from the family, and the value of a “Farewell Done Right.”

We live in an age where some feel goodbyes are not important. I would however challenge this and contend that “A Farewell Done Right” whilst invariably differing from family to family, is such an important step in learning to live beyond a death.

Michael Powell – General Manager Davis Funerals

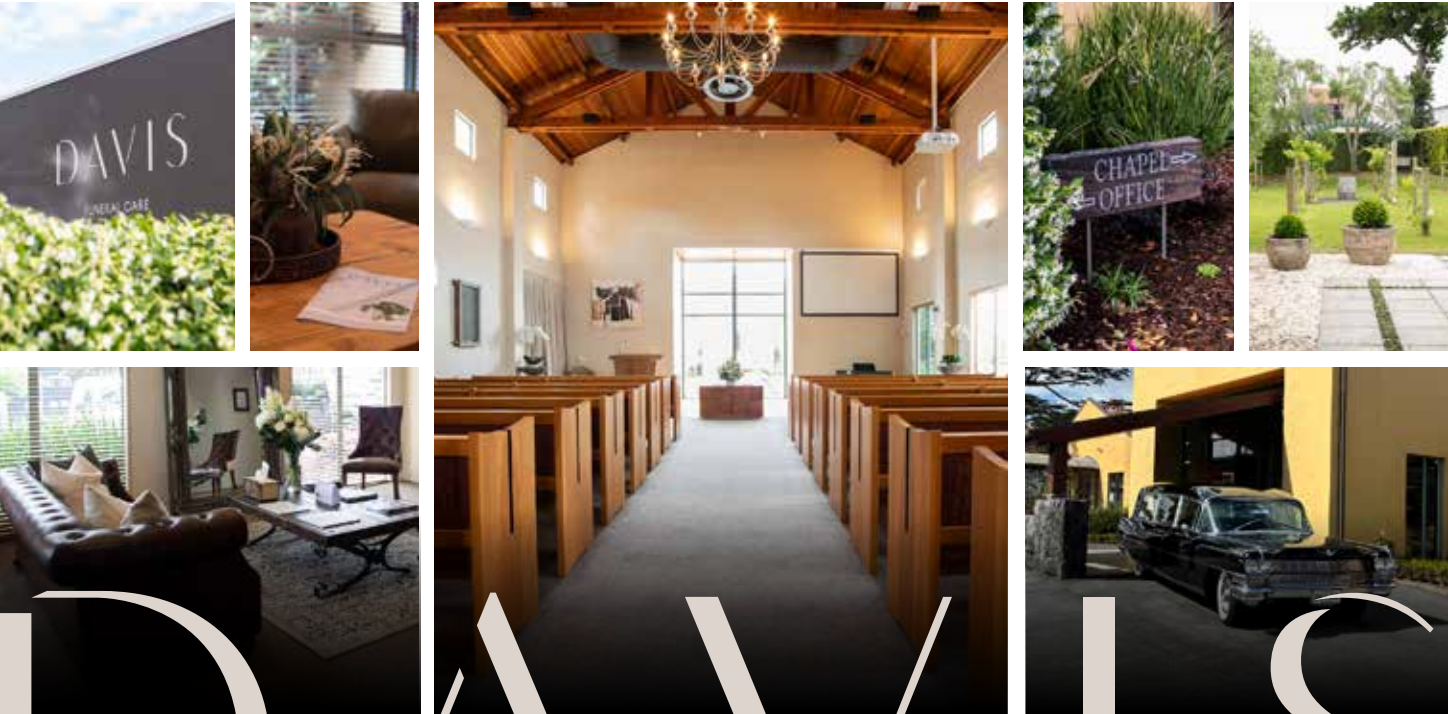

DAVIS
FUNERAL CARE
09 638 9026
DAVISFUNERALS.CO.NZ

Two regions, One unforgettable journey: Slow and comfortable travel – our August and September tours



Our tours are about experiencing more – culture, history and the quiet luxury of time. Boutique Tours France invites travellers to do exactly that with two beautifully curated journeys through France, designed to be taken back to back for an easy travel experience.

The adventure begins with a five-day tour through the Châteaux de la Loire, where France’s royal and renaissance history comes vividly to life. Grand castles, elegant gardens and timeless villages tell stories of kings, queens and creative brilliance. This is cultural touring at its most engaging – never rushed, always time to enjoy and discover.

From there, guests transition smoothly into a fourteen-day exploration of the Dordogne, one of France’s most historically rich regions. Medieval towns, prehistoric heritage, golden stone architecture and local traditions, together we discover a France that feels authentic and profoundly human. History here is lived, layered and everywhere you look.

For those joining both tours, transfer days connect the regions effortlessly. These days are fully organised and guided, transforming travel time into part of the holiday itself. Guests are looked after every step of the way. With a maximum of just eight guests, accompanied by two wonderful, knowledgeable guides, Boutique Tours France offers an exclusive experience that larger tours simply can’t match. Travel is in comfortable, spacious vans, allowing the group to move slowly, enjoy scenic routes and make spontaneous stops. There are no early starts. Days finish around 4 pm, leaving time to enjoy our beautiful accommodation – relax by the pool, play pétanque, walk the garden, read, nap or simply be on holiday. This is slow travel, rich in culture and history, designed for those who want depth without pressure.

Only a few places remain on all our 2026 TOURS.

Discover more at www.boutiquetoursfrance.co.nz.

Catherine Flot
021 025 37338

Patsy Sackx
027 490 4321

Happy New Year from the House of Travel Hobsonville



We are a multi award winning travel agency that specialises in cruises, tours, airfares, package holidays, tailor made itineraries and so much more. If you’re planning to make 2026 or beyond the year to travel,

why not pop in and see us or get in contact? We live, breathe and dream travel, so wherever’s next on your must-visit list, you can bet at least one of our consultants has either been there, or sent someone there. And with our combined experience and knowledge behind you, you’ll always be sure you’re getting the absolute most out of every holiday.

We’re with you every step of the way. We know your down time is precious and we think everyone deserves the best holiday possible. That’s why we promise that whatever curveballs get thrown your way, we’ll help get them sorted for you.

Booking with us is so easy and convenient, whether you have time to pop in and see us in-store, over the phone or in exchange of emails. We are well set up to make the process as easy as possible, no matter where you are. Some of our clients are even overseas.

It’s never been more complicated to leave NZ and return back. With online travel websites not offering accurate information or taking any responsibility for these requirements, booking travel on the internet or Googling the answers to border regulations in an ever-changing environment, is a massive risk to take.. With the security of a physical store, experienced consultants, 100% Kiwi business owner operated, TAANZ bonded and local, who better to be your travel agent wingman?

Your ideas + our knowledge = better holidays. Please keep us in mind when planning and booking your next trip.

Buzz and the team at House of Travel Hobsonville, 225 Hobsonville Point Road (Cnr Hobsonville Point Rd and De Havilland Rd) Hobsonville. Hobsonville@hot.co.nz 09 416 0700

NOW OPEN MON-FRI 9AM-5.30PM
+ SATURDAYS 10AM-3PM

NEW ZEALAND'S MOST AWARDED TRAVEL GROUP

Cnr Hobsonville Point Rd & De Havilland Rd
09 416 0700 • hobsonville@hot.co.nz

HOUSE OF TRAVEL
HOBSONVILLE

Helloworld Travel Westgate

This award winning office owned by West Auckland local Carolyn Hedley is regularly in the winners circle. They are recognized as being cruise specialists and are a top New Zealand office with Helloworld Travel.

Carolyn Hedley is a Master's Cruise Consultant which was achieved after many cruises and self study, one of the few in New Zealand.

Carolyn has travelled to many corners of the earth having experienced many cruises including the Arctic, Galapagos, Alaska, Mexican Sea of Cortez and many Mediterranean cruises. Her favourites are expedition style cruises and small ship cruising.

Lesley Johns has also experienced lots of cruises and prefers the larger ships with more entertainment options and casinos, so we understand how each person has their own preferences when it comes to cruising.

Nadee Perera is from Sri Lanka and has recently visited Fiji and Samoa and is the go to person for family holidays and particularly if anyone is wanting to go to the beautiful island of Sri Lanka.

The office also has a number of escorted tours and the next one departing in February is our small group to Great

Barrier Island. We still have a few spot available on this 4 night tour and our last one went off extremely well.

Carolyn is taking a small group to the East Coast of the USA in September. This tour has 2 parts, the first one is a 7 night Trafalgar Coach Tour from Boston to New York and travels through New England in the Fall. We then have 3 days exploring New York before embarking on an Azamara Cruise from New York to Montreal. Give Carolyn a call if you want to know more.

Phone 4161799 and email westgate@travel.helloworld.co.nz



Skinscape 360



Take control of your skin health with SKINSCAPE 360 imaging's advanced skin cancer detection and surveillance technology.

We take 92 photos in 2 seconds and render a full 3D avatar of your

skin in 5 minutes. You can use it at home to check for any changes and share it with your doctor.

3D Skin Cancer Scans are the future of skin cancer detection.

SKINSCAPE 360 is a skin detection and surveillance clinic that supports patients and medical professionals in the early detection and investigations of potentially cancerous spots.

As a specialist imaging service, we provide our services to the general public, plastic surgeons, dermatologists, skin cancer doctors and general practitioners.

Visit SKINSCAPE 360 at The Specialists Takapuna. L2, 3 Anzac Street Takapuna

www.skinscape360.co.nz 09 8699 360

Kumeu's 24/7 Integrative vet clinic

Gold-standard medicine.

Whole-animal care.

No compromises.

They said a small-town vet couldn't do it differently. That compassionate care and cutting-edge science couldn't live in the same room.

Dr. Fi proved them wrong.

111 Vet Clinic wasn't built by chance. It was built by grit, sacrifice, and an unshakable commitment to animals and the people who love them. She's not just a vet. She's a visionary – one who took the hard road when others took shortcuts.

When your pet's health is on the line, good enough is never good enough. At 111, you're not walking into a clinic. You're stepping into a movement – one built on loyalty, trust, and a promise to do more, be more, and give more.

EUROPE TOURING ON SALE

Plan your adventure early for the best deals. Book with your friendly, local Helloworld Travel Westgate team for stress-free travel and peace of mind - wherever you roam. Expert advice at the best price.



TRAFALGAR 10 DAY CASTLE & KILTS

LONDON - OXFORD - STRATFORD-UPON-AVON - BIRMINGHAM - LLANGOLLEN - TATTON PARK - LANCASTER - EDINBURGH

- INCLUDES:**
- 9 nights hand-selected hotel accommodation
 - 9 Breakfasts, 4 Dinners
 - Must-see sightseeing, transport in a luxury air-conditioned coach with Wi-Fi
 - An expert Travel Director and professional Driver & more

9 NIGHTS FROM **\$5,314*** PER PERSON TWIN SHARE



TRAFALGAR 13 DAY BEST OF ITALY

ROME - VATICAN CITY - POMPEII - CAPRI - ASSISI - VERONA - VENICE - MILAN - LAKE COMO - PISA - FLORENCE - SAN GIMIGNANO - ROME

- INCLUDES:**
- 12 nights hand-selected hotel accommodation
 - 12 Breakfasts, 6 Dinners
 - Must-see sightseeing, transport in a luxury air-conditioned coach with Wi-Fi
 - An expert Travel Director and professional Driver & more

12 NIGHTS FROM **\$6,786*** PER PERSON TWIN SHARE



Helloworld Travel Westgate

09 416 1799 Westgate Lifestyle Centre, 57-61 Maki Street, Westgate
carolyn.hedley@travel.helloworld.co.nz helloworld.co.nz/Westgate

helloworld TRAVEL THE TRAVEL PROFESSIONALS

*Terms and Conditions apply. Valid for travel: Selected dates between 01 Jan - 31 Dec 2026. Seasonal surcharges may apply. See in store for full details



CLARE GUNN Chief Dermoscopist

I am pleased to announce that I will be joining Skinscape 360, an innovative new skin cancer clinic opening in Takapuna, alongside Associate Professor Richard Martin.

Skinscape 360 represents a significant advancement in skin cancer care in New Zealand, bringing together specialist clinical expertise with cutting-edge technology, including 3D total body photography and artificial intelligence. This integrated approach enables earlier detection, more precise monitoring, and a truly patient-centred experience.



I am excited to be part of a clinic that is redefining how skin cancer is detected and managed, and setting a new benchmark for excellence in care.

3 Anzac Street Level 2, Takapuna
09 8699 360 · hello@skinscape360.co.nz

SKINSCAPE 360



Food & Beverage

Hazel's Fruit & Popcorn Granola

ingredients

- 500gm rolled oats
- 3/4 cup grapeseed oil
- 5 tbsp liquid honey
- 1 tsp cinnamon, ground
- 1 cup sunflower seeds
- 1 cup pumpkin seeds
- 3/4 cup almonds, but we can use any nuts
- 3/4 desiccated coconut
- 1 cup cranberries or blueberries
- 1 cup raisins
- Popped popcorn

Pre-heat your oven to 180*c

Take a large roasting tray and line it with baking paper.

In a large bowl combine the oats, cinnamon, sunflower seeds, pumpkin seeds, nuts and coconut.

Mix well before adding the honey and oil, and combine again before spreading out on the roasting tray.

Bake for 10 minutes, before removing from the oven and stirring well with a spoon. Place back into the oven and bake for a further 10-15 minutes or until the mixture is nice and brown.

Remove from the oven and stir in the dried fruits. Mix again and allow to cool completely before adding in some popped popcorn store in an airtight container



Credit- Good FROM scratch



Everything you need to know about property

Property Hub



West Auckland Property Management
2 Clark Road, Hobsonville
09 832 0832



What's inside

19
24
28
41

Property News
Property Statistics
Property Market
Home & Garden



ENQUIRIES / FEEDBACK / ADVERTISING:
E editorial@kumeucourier.co.nz
W Property-hub.nz

COVER PHOTO: WAPM - Aria, Graham & Angie
PRINT RUN: 22,500 copies, Treehouse Print

Property News

19

Introducing Angie!



With over six years' experience in property management, I have successfully managed diverse portfolios of apartments and residential homes across Auckland. I bring a strong understanding of the Residential Tenancy Act and the local market, and I take a practical, proactive approach to

property management, delivering efficient and attentive service. I pride myself on clear communication, strong attention to detail, and building positive, long-term relationships with both owners and tenants to achieve the best possible outcomes.

A lifelong West Auckland local, I grew up in Piha Beach and have a deep connection to the surrounding communities. Outside of work, I enjoy spending quality time with my partner and daughter, as well as catching up with friends and family.

Many thanks, Angie

A local approach to Property Management in West Auckland

Property management plays an important role in looking after rental homes and supporting both owners and tenants. Based at 2 Clark Road, Hobsonville, West Auckland Property Management operates with a practical, people-focused approach supported by a small, dedicated team.

Tracy looks after the accounts, managing rent processing and owner statements to ensure financial information is clear and accurate. Her role provides consistency and reliability behind the scenes, giving property owners



confidence in the day-to-day running of their rentals.

The property management team is led by Angie and Aria, who manage the ongoing care of rental properties across West Auckland. Their work includes tenant selection, routine inspections, maintenance coordination, and communication with both owners and tenants. With strong local knowledge, they respond to issues

promptly and aim to keep tenancies running smoothly.

For owners exploring property management options or seeking initial advice, Graham manages all new enquiries. He works with landlords to explain processes, expectations, and next steps in a straightforward manner. Graham can be contacted at graham@wapm.co.nz or on 027 632 0421.

Angie is available directly on 027 499 8415, and Aria can be reached on 022 090 1416, ensuring owners and tenants have clear points of contact.

With a focus on clear communication, consistency, and local understanding, the team continues to support rental properties throughout West Auckland in a practical and professional way.

Fast & Free Rental Appraisals

Residential rental property advice that's timely, accurate, and measured, to ensure your property gets the attention required. It's a process that builds on 25 years of success and succession.

PHONE:

09 832 0832

www.wapm.co.nz

West Auckland Property Management

Personalised Property Management Solutions

Residential rental property advice that's timely, accurate, and measured, to ensure your property gets the attention required. It's a process that builds on 25 years of success and succession.

Ph 09 832 0832

West Auckland Property Management

Probate threshold raised: what you need to know by Debra Barron, Principal at ClearStone Legal



In September 2025, the probate threshold increased from \$15,000 to \$40,000 – the first update in over 15 years. This change aims to reduce delays and costs for families managing modest estates.

What is probate?

Probate is a court process that confirms a will and authorises executors to distribute assets.

Previously, if someone died with more than \$15,000 in assets in their sole name, probate was required before banks, KiwiSaver providers, and in some cases, insurers could release funds.

What’s changed?

- No probate needed for estates under \$40,000 (as long as there’s no land or property, shares or vehicles).
- Estates over \$40,000 or involving land or property still require probate.

Why the increase?

The old limit of \$15,000 was set in 2009 – before the implementation of KiwiSaver. Too many small estates were unnecessarily caught in the probate process. The new threshold reflects modern realities and eases the burden on grieving families.

Benefits

- Faster access to funds
- Lower legal costs
- Less stress for families
- Frees up court resources for complex cases

What stays the same

- You still need a valid will

CLEARSTONE
LEGAL

Call now to discuss your legal needs

p: 09 973 5102
w: cslegal.co.nz

Kumeu Office
1A Tapu Road, Kumeu

Te Atatu Office
1/547 Te Atatu Road
Te Atatu Peninsula

- Estates with property, shares or assets above \$40,000 require probate

We recommend you review your will and estate plan to ensure your wishes are clear, review every seven years or when there is a change of circumstances (relationships beginning or ending, birth or adoption of a child, loss of a loved one).

If you would like help with your estate planning feel free to contact the team at ClearStone Legal with offices in Te Atatu Peninsula and Huapai. Phone 09 973 5102 or email admin@cslegal.co.nz to enquire further.

Notices of Interest against property titles

What happens if your relationship breaks down, but you are not registered on the title of your shared home? This situation can make you feel like your former partner has the power to sell your shared home without your agreement. However, the Property (Relationships) Act 1976 gives partners who are (or have been) in a qualifying relationship with their partner the power to protect their interest in the shared home – even if their name is not on the title.

Section 42 of the Act allows the non-registered partner to lodge a notice of claim on the property title. Once lodged, a Section 42 Notice has the same effect as a caveat. It prevents the registered owner from selling or otherwise dealing with the property without the non-registered partner’s agreement.

To lodge a Section 42 Notice, you must have been in

KEMP BARRISTERS
& SOLICITORS

your local team of legal experts

Property Law

Litigation

Family & Relationship Law

Wills & Estates

Commercial Law

Trust & Asset Protection

info@kempsolicitors.co.nz
09 412 6000
25 Oraha Road Kumeu

KEMP BARRISTERS & SOLICITORS LTD

K

Property News

21

qualifying relationship with either the registered owner of the land, or a person who is beneficially entitled to the land. A qualifying relationship is a marriage, a civil union, or a de facto relationship of more than three years. You must also have a potential interest in the land because of your qualifying relationship with that owner.

If you consider that a Section 42 Notice could help you, or if you have had one served on you, feel free contact Kemp Barristers and Solicitors at info@kempsolicitors.co.nz or give us a call on 09 412 6000.

Rental Market Report

Auckland’s rental market shows a strong renter’s market with more properties, delivering increased choice, more incentives and lower cost to Renter’s. A surge in new listings up 20% in late 2025, has delivered an over-supply as developers fail to sell and add property to the rental pool. Rents in other areas not

subject to the flourish of development are stabilizing or slightly rising for quality properties offering good storage, parking and security. Demand from migration is anticipated to tighten the rental market later in the 2026, shifting from an oversupply to a potential shortage by 2027.

Professional property management, great property presentation, and strategic pricing are key for landlords seeking to attract a good tenant that looks after the property and provides a secure income over an extended period of time.

Some of the high desirables being sought by Tenants are:

- Garaging
- Street Parking
- Storage
- Easy plug in charging options
- Generous room sizes
- Away from flood risk areas

West Auckland Property Management offers an excellent property management experience with over 25 years in market. Talk to Graham McIntyre today about your rental property, gain a free and fast rent appraisal and discuss the differences that make West Auckland Property Management your preferred choice.

Phone 0276320421 or email graham@wapm.co.nz.

Henderson
Reeves

creating smart legal solutions

Property • Disputes • Family • Wills

Taina Henderson027 537 9222

Shelley Funnell027 537 9221

Amie Wallwork021 421 336

www.hendersonreeves.co.nz

LAND LAW

CLIENT CENTERED CONVEYANCING

CONVEYANCING – SALE or PURCHASE FROM

\$899 plus GST & disbursements Call now 022 1077 800

office@landlawnz.com www.landlawnz.com

VODANOVICH
LAW

SALES & PURCHASE OF REAL ESTATE
RELATIONSHIP PROPERTY | BUSINESS STRUCTURES
POWERS OF ATTORNEY | WILLS & TRUSTS
COMPANY & EMPLOYMENT LAW

PLEASE CONTACT IVAN

ivan@vlaw.co.nz 09 412 8000

4a Shamrock Drive Kumeu, Auckland

Local Lawyers,
Helping Develop &
Grow West Auckland
Business & Community

smithpartners.co.nz | 09 836 0939

smith
AND PARTNERS

LAWYERS

Property report



Average national residential property values rose in the December quarter, due mainly to Christchurch's property price stability, but a glut of homes for sale in Auckland means buyers start 2026 with the upper hand.

QV's House Price Index shows average residential property values across New Zealand rose 1.1% in the December quarter from the prior September quarter, lifting the national average to \$910,118. Although that's 0.9% higher year-on-year, it's 13.1% below the national peak in January 2022.

The QV HPI uses a rolling three month collection of sales data, based on sales agreement date.

The December quarter rise follows a prolonged period of flat or falling values during much of 2025.

Big numbers of property listings remains a key housing market driver with over supply being a major contributor to lower prices in many areas. . The three big property portals ended 2025 with huge volumes of properties for sale. Realestate.co.nz had more than 30,000 for sale listings, TradeMe Property had more than 41,000, and OneRoof had over 38,000.

"With the number of homes for sale nationwide at the highest level in a decade, buyers continue to have dominance, with more choice and the ability and power to negotiate. This is keeping value movements in check, even as activity surges in areas like Christchurch. That dynamic is also contributing to improved affordability in relative terms, particularly for first home buyers.

Of the main cities, Christchurch recorded the strongest quarterly growth at 2.5%. Next was Hamilton at 2.1%. The Auckland Region recorded a 0.8% increase, with Dunedin up 0.4%. Wellington City dropped 0.5%.

Auckland and Christchurch, apartments and townhouses face pricing pressure because of supply, higher building and servicing costs, and because values for stand-alone homes have fallen.

"In many cases, buyers are choosing houses on their own sections offering more storage, privacy, living space and carparking over townhouses or apartments that lack these amenities and are often not significantly cheaper to purchase and often over encumbered by body corporate, resident group fees or laneway fees.

We're also seeing the effects of a reset in development land values in some locations, following elevated prices paid during the previous peak such as the Waitākere ward where values have dipped more sharply. With QV CostBuilder data showing building costs remain elevated compared to pre-peak levels, alongside higher interest rates, some developers who paid a premium for land during the peak can no longer afford to develop or hold it, resulting in land being resold in some cases at

significantly lower prices than originally paid.

If you haven't heard, it's an election year. This can create a degree of caution, which may restrain activity at times as buyers and sellers take a more wait-and-see approach. As a result, any change in values is expected to be gradual rather than rapid.

The average home value across Auckland is now \$1,204,006, with values 3.3% below where they were at the same time last year, and 20.6% below the nationwide peak of January 2022.

Lower prices have improved affordability for some buyers. However, interest rates remain much higher than during the peak which means servicing debt is still a barrier to many potential buyers.

The suggestion to buyers is talk to a Mortgage Broker early, understand your position and get your paperwork in order. If you are buying a plaster-coat home or a lifestyle property, be sure to talk this through with your broker as some banks are negatively pre-disposed to lending on some types of property.

If you are seeking to rent, sell, or buy in this challenging market, it pays to talk to an agent that is experienced, trusted and capable.

Contact -

Brendon Hodge 021 608 234 or

Graham McIntyre 027 632 0421

from Raine & Horne Real Estate Kumeu - Hobsonville.

A Real Estate team that provides proven results and excellent service. Country Living Realty Limited. Licensed (REAA2008)



Raine & Horne

Brendon Hodge
Licensed Sales Person

m 021 608 234
brendon.hodge@kumeu.rh.co.nz
327 Main Road, Kumeu, NZ 0810
Raine & Horne - Kumeu | Hobsonville Country Living Realty Ltd Licensed REAA (2008)





Raine & Horne

Graham McIntyre
Licensed Agent
Kumeu | Hobsonville

027 632 0421
graham.mcintyre@kumeu.rh.co.nz
Raine & Horne New Zealand PTY Ltd Licensed REAA(2008)



Local expertise, global connections

Terry Jones has a background in farming and in his later years, property development and has worked in the real estate industry for over 20 years. He has a vast knowledge and energy in residential, lifestyle commercial and development which he is passionate about.

With a combined 45 years, this professional team Terry and Janet Jones, are experienced in the real estate industry and have a wide knowledge of the local areas and the current market. Terry and Janet are a highly motivated, highly skilled and experienced team producing results that go above and beyond their client's expectations.

Well recognised faces amongst the Hobsonville, West Harbour and Whenuapai community, Terry and Janet have a reputation for outstanding service and results. These results have seen them awarded winning 'top achievers' office and nationally in Real Estate for over a decade.

Underpinning their approach to selling property is a strong set of family values, trust, and integrity which ensures that they have no stone unturned when it comes to providing superior customer service. Team Terry Jones are a committed team, working cohesively to produce outstanding results they continually achieve for their clients.

Janet has over 25 years of experience in the real estate industry and with a background in sales for an international company, she is instrumental in creating comprehensive marketing campaigns tailored to individual properties which create maximum exposure to potential buyers to gain the best results for their clients.

Combined with Terry's knowledge and experience, Team Terry Jones understands that when it comes to choosing an agent, (s) it is vital that they understand implicitly that this may be one of your largest assets and that they take that responsibility seriously.

Terry and Janet Jones have resided in the Hobsonville area for 30 years and enjoy family life, sport, getting together with friends and being involved with the local schools and community.

Team Terry Jones chose New Zealand Sotheby's International Realty

Team Terry Jones

30 years of Experience.
Servicing Local & Global.

Terry and Janet Jones
Lifestyle Residential Development
M +64 27 492 0529
terry.jones@nzsiir.com



New Zealand | Sotheby's INTERNATIONAL REALTY

What comes next for the New Zealand market in 2026?

Many market commentators expect 2026 to see real estate growth, with the weaker phase of the Kiwi market over the past four years behind us. Key questions remain around the pace of growth and potential headwinds, including global issues, regulatory debates, and a possible capital gains tax ahead of the year-end election.

Economically, there are positives. The Reserve Bank of New Zealand forecasts GDP growth of around 3% in 2026, with rising employment and a lower unemployment rate, supporting property sales and house prices. The latest MintHC survey by economist Tony Alexander shows strong business confidence, with many planning increased recruitment and rising inventories for the first time in almost three years.

Cotality's 2026 outlook highlights that 2025 mortgage rate cuts will continue to benefit households and support housing activity, with around 12% of loans on floating rates and 33% due to reprice within 3-6 months. They anticipate property sales to rise from around 90,000 in 2025 to 100,000 in 2026, with national median property values potentially growing by 5%.

Raine & Horne New Zealand General Manager James Shepherd noted strong activity for first-home buyers and investors in 2025, with regional variations. Markets tied to agriculture, such as Canterbury, Southland, and Waikato, performed well, while Auckland and some main centres were softer. Raine & Horne expects increased demand in 2026 as economic recovery continues.

For buying or selling property, contact your local Raine & Horne office: raineandhorne.co.nz/kumeu.

Credit: Raine & Horne headoffice



NEW ZEALAND PROPERTY™
Licensed REAA 2008
Stephen Hudson
Executive Salesperson & Company Owner
REA Licensed & MREINZ
0274 746 774
Stephen@Horne.co.nz



Residential, Commercial, Developments, Lifestyle, Rural, Waterfront
www.NewZealandProperty.co.nz

Area Property Stats

PROPERTY-HUB.NZ

Every month Raine & Horne Kumeu assembles a comprehensive spreadsheet of all the recent sales in the area that reviews the full range of Residential and Lifestyle transactions that have occurred. To receive the full summary simply email the word “full statistics” to office@kumeu.rh.co.nz. This service is free from cost.

SUBURB	STREET	CV	BED	FLOOR AREA m2	LAND AREA m2	SALE PRICE
Coatesville						
	Sunnyside Rd	\$2825000	6	377	13000	\$2725000
Helensville						
	Hand Road	\$900000	4	129	1161	\$895000
	State Highway 16	\$1700000	3	180	41500	\$1700000
	Inland Road	\$1775000	0	240	18200	\$1595000
	Kaipara View Rd	\$1550000	4	182	13900	\$1680000
	Karaka Street	\$740000	4	146	0	\$725000
	Downer Street	\$910000	3	170	813	\$860000
	Urumaraki Ave	\$1880000	0	309	11100	\$1495000
Herald Island						
	n/a					
Hobsonville						
	Bomb Point Drive	\$1250000	4	187	0	\$1250000
	Greenfinch Road	\$1150000	4	195	227	\$1087500
	Shelduck Way	\$770000	2	85	104	\$745000
	Silvereye Road	\$1125000	4	182	207	\$1125000
	Nugget Avenue	\$1125000	3	171	195	\$1065000
	Mayfly Lane	\$850000	3	118	61	\$885000
	Buckley Avenue	\$750000	2	58	0	\$615000
	Marlborough Cres	\$1275000	2	75	0	\$1142000
	Liquidambar Drive	\$1495000	3	171	258	\$1265000
	Kokowai Parade	\$1575000	5	286	357	\$1572500
	Kerewhenua Cres	\$720000	2	82	89	\$740000
	Hudson Bay Road	\$1100000	3	156	152	\$1070000
	Bomb Point Drive	\$1025000	2	185	0	\$960000
	Onekiritea Road	\$1125000	4	189	182	\$1117000
	Curtiss Circle	\$620000	0	0	239	\$534000
	David Carnegie Road	\$970000	3	111	151	\$955000
	Hobsonville Pt Road	\$780000	2	111	0	\$745000
	Onekiritea Road	\$630000	1	66	63	\$609500
Huapai						
	Sunny Crescent	\$1750000	5	275	1540	\$1440000
	Maple Lane	\$1350000	4	250	0	\$1300000
	Ara Kakara Avenue	\$1225000	3	175	605	\$1175000
	Podgora Avenue	\$490000	0	0	323	\$353400
Kumeu						
	Fruitlands Road	\$1375000	4	228	662	\$1392500
	Nellie Drive	\$1100000	4	160	406	\$1125000
	McIndoe Road	\$1300000	4	195	566	\$1266000
	Cutfield Lane	\$1350000	5	212	615	\$1365000
	Schoolside Road	\$1100000	4	195	237	\$1090000
Massey						
	Mahinga Place	\$990000	4	182	350	\$950000
	Woodside Road	\$820000	3	140	414	\$860000
	Anich Road	\$975000	3	70	2256	\$800000
	Kopi Place	\$730000	3	80	613	\$693500
	Puhikawa Street	\$380000	3	0	137	\$840000
	Helena Street	\$940000	3	120	675	\$885000
	Vina Place	\$960000	5	170	984	\$985000
	Kotiu Place	\$400000	3	0	164	\$835000
	Reybert Place	\$1075000	3	180	643	\$1212500
	Royal Road	\$1275000	3	250	809	\$1245000
	Kemp Road	0	3	0	0	\$665000
	Petrel Place	\$750000	2	130	0	\$778000
	Cyclarama Cres	\$630000	2	70	138	\$570888
	Triangle Road	\$710000	2	80	0	\$726000
	Clyma Place	\$910000	3	93	1092	\$762000
	Moxham Grove	\$810000	3	100	716	\$870000
	Exotic Place	\$810000	4	157	450	\$835000
	Halloran Place	\$710000	3	90	328	\$710000

SUBURB	STREET	CV	BED	FLOOR AREA m2	LAND AREA m2	SALE PRICE
Riverhead	Cityview Place	\$1030000	3	157	451	\$1050000
	Tiriwa Drive	\$620000	2	74	91	\$605000
	Granville Drive	\$870000	3	90	989	\$956000
Taupaki	Ridge Road	\$1050000	0	0	11900	\$900000
	Pohutukawa Parade	\$1600000	4	224	882	\$1390000
	Pohutukawa Parade	\$1625000	4	214	917	\$1592000
	Tauwaka Crescent	\$1650000	4	296	812	\$2185000
	Crabb Fields Lane	\$1400000	4	202	1130	\$1412500
	Munford Lane	\$1525000	4	212	801	\$1700000
	Maude Street	\$1050000	4	155	585	\$1050000
	Albert Street	\$900000	3	110	810	\$775000
Waimauku	Arthur Street	\$1250000	4	127	730	\$1198000
	Hunter Road	\$1725000	5	280	41400	\$1610000
Waitakere	Taupaki Road	\$1900000	3	211	12000	\$1800000
	Sarah Todd Lane	\$1050000	4	150	2204	\$1310000
	Pukemarino Road	\$1225000	4	217	804	\$1410000
	School Road	\$580000	0	0	4185	\$460000
	Valley Road	\$1300000	3	85	67800	\$1410000
Wes Harbour	Taylor Road	\$1940000	4	260	11700	\$1890000
	Caton Road	\$1060000	1	140	40000	\$940000
Wes Harbour	Scenic Drive	\$1200000	3	188	2933	\$1265000
	West Harbour Dr	\$1475000	4	270	581	\$1350000
	Westpark Drive	\$1550000	5	230	852	\$1595000
	Connemara Court	\$1475000	4	240	600	\$1650000
	St Catherine Cres	\$770000	3	0	67	\$770000
	Forster Place	\$930000	3	82	569	\$760000
	Cherub Place	\$1400000	4	220	623	\$1375000
	St Catherine Cres	\$780000	2	83	115	\$690000
	West Harbour Drive	\$1950000	5	490	1093	\$1775000
	Woodhouse Place	\$950000	3	126	147	\$857000
	Lagoon Way	\$1165000	3	222	715	\$1120000
	Crosby Road	\$720000	2	112	62	\$700000
	West Harbour Drive	\$860000	3	118	152	\$860000
	West Harbour Drive	\$860000	3	118	157	\$860000

DISCLAIMER: These sales figures have been provided by a third party and although all care is taken to ensure the information is accurate some figures could have been mis-interpreted on compilation. Furthermore these figures are recent sales over the past 30 days from all agents in the area.

Graham McIntyre on 027 632 0421

Brendon Hodge on 021 608 234

Country Living Realty Limited T/A Raine and Horne Kumeu
- Hobsonville. Licensed REAA (2008).

Raine & Horne Kumeu also provide statistical data FREE from cost to purchasers and sellers wanting more information to make an informed decision. Phone me today for a FREE summary of a property and surrounding sales, at no cost and no questions asked. Graham McIntyre 027 632 0421 *Available for a limited time. Conditions apply.

Raine&Horne®

This page is sponsored by Raine & Horne Kumeu - Hobsonville
Phone 0800 900 700 Country Living Realty Ltd Licensed REAA (2008)



There’s a lot happening right now in the world of property and finance.

The latest Cotality Home Value Index shows property values dipped in December, with the national median value now \$808,403. Here in West Auckland, the average home value is currently around \$921,680.

The property market has also seen more homes coming onto the market. Data from realestate.co.nz shows there were 30,390 properties listed for sale in December, up 3.1% compared to last year and the first time in a decade that December listings have topped 30,000. This is giving buyers more choice but also creating more competition for sellers.

On the finance side, there’s plenty to watch as we head into 2026.

The next Official Cash Rate announcement is scheduled in late February. Many fixed-rate home loans are coming up for renewal. And for a lot of households, summer spending has crept up more than planned.

This time of the year is a good moment to pause. And when it comes to your finances, it’s a chance to reset. The simple question I’m asking clients is:

“Does your financial set up still match your current situation, and is it helping you, your family and your goals for the year ahead?”

Life changes quickly. New homes, jobs, growing families, rising costs, new priorities and plans – all of these can make the setup that once worked perfectly become quietly outdated.

Taking some time for an annual check-in can make a real difference – helping you feel better prepared for whatever this year brings.

To make this easy, we’ve created a simple Financial Reset Checklist.

You can scan the QR code with your phone to access it. It’s free and designed to help you see what’s working well, what might need a refresh, and where a short conversation could really help.

If you tick even one box, that’s your cue to get in touch.

Call Ben Konings
Your Local Mortgage Adviser
0204 1122 481
ben@mortgagesupply.co.nz

Scan for your
2026 Financial Reset



Your Local Mortgage Adviser

- First Home Buyers
- Property Investors
- Upsizing & Downsizing
- Repayment Strategies

2025 TOP BROKERAGE NZA

2024 TOP BROKERAGE NZA

2024 TOP MORTGAGE EMPLOYER NZA

Ben Konings

0204 1122 481

ben@mortgagesupply.co.nz

THE Mortgage SUPPLY CO. LTD.



Relax.
We’ve Got 2026 Covered.



Start the New Year knowing your property is in expert hands. At West Auckland Property Management, we combine 25 years of local knowledge with a personal, results-driven approach to make property ownership effortless.

We’re invested in your investment.

Give our Property Experts a call today to find out how we can make your property work for you

09 832 0832

027 499 8415

office@wapm.co.nz

West Auckland Property Management

Office locations:

2 Clark Road, Hobsonville

327 Main Road, Kumeu



A World Away – Home with Income

169 Awa Road, Kumeu

A tranquil and quiet valley, away from the bright lights, and the countless cars, and yet close enough for a dinner out or a quick dash for milk. Welcome to Willow Tree Cottage. A home that entangles lifestyle with convenience and the mixed comforts of uncompromised alfresco living with access from Dining, Lounge and Bedrooms. A home that is two: A four bedroom, two bathroom, two lounge single living family homestead 186sqm, and... Off a separate

drive, a stand alone home offering three bedrooms, one lounge, one bathroom 86smq being a home or an income. Independent appraisal range is around \$700 per week for this.

The landscaping is impressive, stepping you down to a mixture of accessory buildings and converted stables now transformed into the ultimate lifestyle zone, complete with a home gym, bar area, and chill-out space for entertaining or unwinding.



- Featuring:
- 7 bedrooms
 - 3 bathroom
 - 2 living
 - 3 garage
 - Land area 4.05 Hectares
 - Floor area 275 sqm
 - Lifestyle Property
 - Two houses
 - Man cave



For more information on this property call:
Graham McIntyre on 027 632 0421
or email: graham.mcintyre@kumeu.rh.co.nz
Country Living Realty Limited T/A Raine and Horne Kumeu
- Hobsonville. Licensed REAA (2008).



Gold Award Winner 2021 – Modern Family Home

38 Vinistra Road, Kumeu

Up-beat urban family living at it's best in Huapai. This ultra-modern, single level, and super-comfortable, surprisingly spacious 3-bedroom, 2 bathroom award winning home, promises to deliver a wow experience. If you are a discerning buyer looking for a home that is clever, well constructed, and appointed to a very high standard, this home should be on top of your list. Warm timber pavilions invite you inside this light-drenched, architecturally designed home. High raked ceilings add elegance and space to the combined kitchen and living area. A wrap-around hardwood

deck offers uncompromised indoor-outdoor flow and connects with the master and secondary bedroom. Despite its modest budget, 38 Vinistra boasts premium black detailing and fixtures that put it a class above the rest. This beautiful Maddren Home has all the extras and all the conveniences for easy family living.

For more information on this property call:

Graham McIntyre on 027 632 0421

Country Living Realty Limited T/A Raine and Horne Kumeu
- Hobsonville. Licensed REAA (2008).





Featuring:

- 3 Bedroom
- 2 bathrooms
- Land area 472 sqm approx
- Floor area 162 sqm approx
- 2 Garage
- Huapai triangle location
- Close to school, park, shops, cafes
- Easy access to walking tracks
- Note- Images represent 2021 showhome



MINOR DWELLINGS

How a minor dwelling could benefit you.

Building a Minor dwelling is just about to get a whole lot easier! With new regulations that have come in, now is the time to start thinking about how a minor dwelling could benefit you.

We offer a range of minor dwelling plans, as well as the capability to incorporate your ideas, and customise plans to suit your needs. G.J. Gardner gives you peace of mind, taking care of the project from start to finish, including all site services, meaning no hidden surprises.

Fully complying with the NZ Building code, you can rest assured in the comfort and long term performance of a brand new G.J. Gardner compact home.

With our proven systems and processes, we are able to provide certainty with pricing and the completion date of your project.

Enquire with GJ's Rodney West today.

09 412 5371 / gjgardner.co.nz

G.J. Gardner. HOMES



Asking price \$649,000

2 Riverpark Crescent, Henderson

This tidy, stand-alone home features two double bedrooms, one bathroom, a separate toilet, and a comfortable living area, all within an 80m² (approx.) floor area. The layout is practical, easy to live in, and perfectly suited as an entry into the property market or a solid addition to an investment portfolio. Four off-street car parks provide excellent convenience - a rare feature for a property of this size. The flat section also offers potential to add value over time or explore future development opportunities (subject to council approval). Located in a popular Henderson neighbourhood, the property is close to local schools, parks, public transport, shopping, and amenities, with easy access to main arterial routes.

Don't miss this chance to secure a versatile property with great potential. Contact us today to arrange a viewing! Graham - 0276320421 or Glenn - 0275998415

For more information on this property call:

Graham McIntyre on 027 632 0421 or Glenn Savery 027 5998415. Country Living Realty Limited T/A Raine and Horne Kumeu - Hobsonville. Licensed REAA (2008).

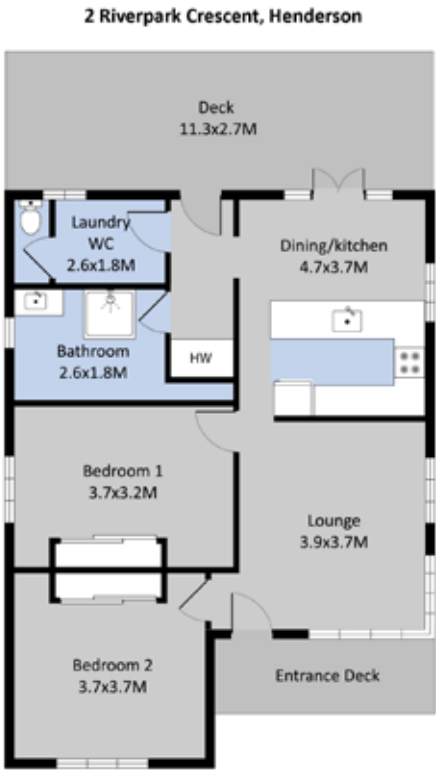

Featuring:

- 2 bedroom & 1 bathroom
- Land area 319 sqm & Floor area 80 sqm
- Stand alone
- Fully fenced
- Cul-de-sac location
- Private & secure
- Close to bus stop
- Good off-street parking for multiple cars
- Fee simple freehold site



Summer Camping & Hosting in True Kiwi Style

Kiwi Camping

Kingfisher Kingfisher 4 Air Tent 4 Person



SKU: 387782

\$799

Kiwi Camping

Kingfisher Kingfisher Recreational Tent



SKU: 382260

\$349

Kiwi Camping

Kingfisher 4 Recreational Tent



SKU: 2053510

\$199

Weber

Traveler Compact Portable BBQ Black



SKU: 2036302

\$699

Grilled

Tulsa Portable Gas BBQ



SKU: 2000648

\$299

Meteor

Homestead Portable Gas BBQ



SKU: 2000634

\$199

Kiwi Camping

Table and Bench Set



SKU: 2002766

\$229

Kiwi Camping

Bi-Fold Table with Pantry H: 700mm, W: 1220mm, D: 760mm



SKU: 382267

\$199

Kiwi Camping

Chillax Chair H: 900mm, W: 620mm, D: 600mm Black and Grey



SKU: 368833

\$99⁹⁹

**Big Range,
Low Price,
Local Advice.**

Mitre 10 MEGA Westgate & Henderson
Northside Drive & Lincoln Road
Monday to Sunday 7am to 6pm

@MEGAHenderson



@megawestgate

@mitre10.mega.henderson



**MITRE 10
MEGA**

**WESTGATE &
HENDERSON**



41

Home & Garden

Waimauku Garden Club

Our last get together was our annual Christmas lunch to finish off a fantastic year. It was held at The Hive Bar and Restaurant at Kumeu. We had a meal of a choice of succulent ham or chicken followed by an amazing Eton Mess dessert. To top off the afternoon we had the honour of the one and only Linda Hallinan as our guest speaker. Former NZ Gardener Editor, author, broadcaster, amateur home brewer etc, Lynda has spent half her life writing about her passion for plants. Lynda's garden at Foggydale Farm is (occasionally) open to the public for charity events and includes a barley meadow, lotus pond, orchard of heritage fruit trees, a shepherd's hut filled with dried flowers - pretty much a bit of everything. We had the joy of visiting it in 2023. Linda also had her books, preserves and bunches of flowers to give away as prizes for some lucky ladies.

Can't wait for our next trip to be held on the third Thursday of February.

Feel free to contact any of us: Ann (0210357406), Gail (021344070), Maree (0274963006) Moira (0274989154, Sandi (0273184514)



FieldHomes

Award-winning Master Builder
creating sustainable, high-quality homes for
modern living at affordable price.

Our Services:

- ✓ Design & Build
- ✓ Subdivision
- ✓ Relocatable Home

Talk to us today!

fieldhomes.co.nz

sales@fieldhomes.co.nz

021 0241 0368



Burnetts

SEPTIC & WATER TANK CLEANING

YOUR SEPTIC TANK SHOULD BE CLEANED EVERY 3 YEARS (AVERAGE FAMILY OF 4)

WE SERVICE ALL AREAS

PROMPT, PROFESSIONAL SERVICE WITH 30 YEARS EXPERIENCE

PHONE: 09 412 9210 OR 027 492 4494



Didn't quite finish that holiday DIY painting project?



The holidays are often when homeowners plan to tackle painting projects – a fresh coat in the lounge, weathered exterior walls, or window trims. But DIY painting doesn't always go to plan.

If your project was started but not finished, or some areas just don't look quite right, Focus on Painting can help. We specialise in completing DIY paint jobs, fixing unfinished or patchy work, and delivering high-quality finishes that last.

Our team of qualified local painters works efficiently, using the right preparation, materials, and attention to detail to ensure your home looks its best. All our work is backed by a 5-year warranty, giving you added peace of mind.

Don't let unfinished paintwork linger through summer. Whether it's interior touch-ups, exterior repainting, trims, fences, or full room repaints, we'll take care of it properly – so you can enjoy a fresh, polished home without the stress.

Sometimes the smartest DIY decision is knowing when to hand it over to a professional and enjoy a long-lasting result.

You can see our work and read reviews from happy customers at facebook.com/focusonpainting.

Free quotes are available – call or text Brad on 021 756 890, or email focusonpainting@gmail.com.

HOUSE PAINTING

INTERIOR / EXTERIOR / ROOF

FREE QUOTE & 3 YEAR WARRANTY*

*Conditions Apply



Brad 021 756 890

focusonpainting@gmail.com

facebook.com/focusonpainting

Win \$30,000 off your new pool



Order a Narellan Pool before 31 March 2026 for the chance to win \$30,000 off your pool.

To enter, simply place your pool order before 31 March 2026 and you'll automatically go into the draw.

Trusted by families across New Zealand for decades, Narellan Pools provides locally manufactured fibreglass pools backed by proven quality and experience. With a wide range of shapes, colours, and styles available, there's a design to suit every home and lifestyle.

If you already have a quote, you can lock it in today and secure your chance to win \$30,000 off your pool. If you've been thinking about getting a pool, why not request a free quote and start your pool journey today? It's an easy first step towards transforming your backyard into a space for relaxing, entertaining, and making lasting memories with family and friends.

To find out more, contact Narellan Pools Auckland West on 0508 476 657 or visit narellanpools.co.nz.

Terms and Conditions: Competition is open to all permanent residents of New Zealand aged 18 years or over who meet the requirements set out in these Terms and Conditions. The promotion opens on Monday, 19 January 2026 at 9:00 AM NZDT and closes on Tuesday, 31 March 2026 at 5:00 PM NZDT. For full terms and conditions visit narellanpools.co.nz/30k-promo/

BRINGING DREAMS TO LIFE WITH NARELLAN POOLS AUCKLAND WEST



Narellanpools

narellanpools.co.nz
0508 476 657



Tough kid 2026 – Building resilience, confidence, and community



Mitre 10 MEGA Westgate and Henderson are proud to once again partner with the Royal New Zealand Air Force (RNZAF) to present TOUGH KID 2026 at Whenuapai AirBase on Thursday, 26 March 2026. This much-loved annual event continues to bring together schools from across West Auckland for a day of challenge, teamwork, and unforgettable fun.

- What is TOUGH KID?**
- TOUGH KID is a high-energy, child-friendly, military-style obstacle course designed for Year 3-6 students. The RNZAF has created a 1-1.5 km course across the base fields and Sioux Block, packed with mud, water features, and physical challenges that test strength, agility, and resilience in a safe and supportive environment. While the course maintains the spirit of previous years, 2026 introduces new twists and obstacles to keep participants engaged and excited.
- Event Highlights**
- Obstacle Course Action: Students will run, climb, crawl, and splash their way through RNZAF-designed obstacles.
 - RNZAF Capability Displays: A range of equipment and vehicles will be on display, giving kids the chance to explore and learn about Air Force operations.
 - Special Demonstrations: Subject to weather and personnel availability, attendees may get to witness a flyover and parachute demonstration—always a crowd favourite.
 - On-Site Entertainment.
 - Prizes for all: Every participant will receive a prize as they cross the finish line.

Registrations & cost

The event is capped at 1,500 participants, with a cost of \$4 per student. All registrations must be made through participating schools, which are asked to assist with coordination and provide teacher or parent volunteers on the day. Schools wishing to take part can request an information and registration pack by emailing marketing.westgate@mitre10.co.nz.

Why schools love TOUGH KID

Each year, TOUGH KID continues to grow in popularity, offering students an incredible opportunity to build

confidence, develop resilience, and work together—while having a fantastic time. The memories created on the course last well beyond the event itself and contribute to stronger school communities.

Mitre 10 MEGA Westgate and Henderson extend their sincere thanks to the RNZAF for their support and collaboration in bringing TOUGH KID 2026 to life. We look forward to welcoming students, teachers, and whānau to Whenuapai Air Base on 26 March 2026 for another action-packed day.

Registrations close two days prior to the event.

For further information or to secure your school's spot, please contact marketing.westgate@mitre10.co.nz

Lincoln Heights school



In the māra (garden) at Lincoln Heights School, learning happens in small, steady ways.

Tamariki plant seedlings, turn compost, feed chickens, and watch what happens when living things are given time and care. The Kāhui Māra Kai sits inside a mainstream school in Massey, but its rhythms are closer to a working garden than a classroom.

Four years ago, it began with a few garden beds and a simple curiosity about what kai-based learning could offer. Since then, it has spread across the school grounds, a sheltered outdoor classroom, compost systems, more gardens, chickens, and a fale that the tamariki speak about with pride. A fale is a Samoan meeting house, built on the border on the māra kai.

"I want others to understand that what I've done is for everyone," one tamariki from Lincoln Heights School says.

The learning is practical. Tamariki know when to harvest, how weather changes the soil, and what happens when something is forgotten. They also know that nothing here works alone.

"Our māra kai shows the beauty of teamwork, how fun it can be and how plants are similar to us. Watching plants grow reminds me of how I'm still growing in this group/ community," another tamariki explains.

Care for the environment is woven through everything.

"I want others to understand the importance of gardens and nature and how we can't survive without it and how we need to take care of our environment," a student says.

There is joy in the work too.

"I really enjoyed this because I really loved being here and having fun with my friends," another tamariki shares.

In this corner of Massey, the māra has become more than a place to grow food. It is a place where responsibility, connection and belonging take root – slowly, collectively, and in the open air.





wallerprojects
MARK WALLER
M: 021 802 845
E: mark@wallerprojects.co.nz
A: The Hangar, Catalina Bay,
2/2 Boundary Road, Hobsonville Point
W: wallerprojects.co.nz
AWARD WINNING DESIGN & BUILD



On To It Garden Services – Taking the hard work out of garden care



Maintaining a beautiful outdoor space takes time, effort, and expertise – and that’s where On To It Garden Services comes in. Known for their reliability and hands-on approach, this local business has built a strong reputation for delivering quality garden care with a personal touch.

On To It Garden Services specialises in a wide range of garden and property maintenance solutions, including lawn mowing, hedge trimming, garden tidy-ups, pruning, planting, and ongoing maintenance programmes. Whether it’s a small residential garden or a larger lifestyle property, the team approaches every job with the same attention to detail and pride in their work.

What sets On To It Garden Services apart is their “get it done right” attitude. They understand that no two gardens are the same, and they take the time to listen to their clients’ needs, offering practical advice and tailored solutions to keep outdoor spaces looking their best year-round.

For homeowners, landlords, and businesses looking for dependable garden services, On To It Garden Services offers peace of mind, knowing their property is in capable hands. With a strong focus on consistency, quality, and customer satisfaction, they truly live up to their name – when it comes to gardens, they’re on to it.



On To It Garden Services Ltd
Calvin Bates
0272 111 075
ontoitgardenservices@gmail.com

ESTD 2004



TACKLE PLUMBING LTD
Certifying Plumber
Plumbing Solutions You Can Trust
021 581 703 – email: rwkennerley@xtra.co.nz



OUR PROFESSIONAL TEAM IS HAPPY TO HELP WITH:

- Septic tank inspections, empties and cleans
- Wastewater system maintenance and disposal
- Grease trap cleaning

We can help you ensure you comply with Auckland Council Healthy Waters requirements and the relevant paperwork.

We are proudly NZ-owned with a friendly team who truly care about doing a good job for you.

0800 493 768
www.hydrovac.co.nz



When tree roots go hunting: The hidden impact of dry spells on drains

Tree roots are incredibly intelligent systems. Their sole mission is simple: find water, nutrients, and stability. During long dry spells, when moisture in the soil becomes scarce, roots don’t just stop growing – they go searching. And unfortunately for homeowners, underground drainage pipes are one of their favourite targets.

Drain pipes often contain small amounts of moisture from everyday use, condensation, or tiny imperfections in joints. To a thirsty root, this is an open invitation. Roots will exploit the smallest crack or joint, slowly forcing their way inside. Once in, they thrive – growing thicker, spreading further, and eventually creating blockages that restrict or completely stop wastewater flow.

Over time, these root invasions can cause serious damage. We regularly see collapsed pipes, recurring blockages, sewage overflows, and costly repairs – especially after prolonged periods of dry weather followed by heavy rain.

The tricky part is that the damage is happening out of sight. By the time symptoms appear – slow drains, gurgling, or unpleasant smells – the problem is often well advanced.

Regular CCTV drain inspections and early intervention are key to preventing root damage before it turns into a major (and expensive) issue. When it comes to tree roots and drains, a proactive approach can save a lot of stress down the line

Call or email today to book your ninja! 0800 4 NINJA admin@drainnijas.co.nz



EVERYTHING TO DO WITH DRAINS 24/7

- ✓ Vacuum loading/suction ✓ Septic tank empty & council inspection
- ✓ Cesspit cleaning, pump chambers, grease trap cleaning
- ✓ Hydro excavation, pile holes ✓ Drain unblocking & root cutting
- ✓ CCTV locating & fault finding ✓ Drain repairs & maintenance



LOCALLY FAMILY OWNED & OPERATED
drainnijas.co.nz

0800 4 NINJA 0800 4 64652
Email: admin@drainnijas.co.nz

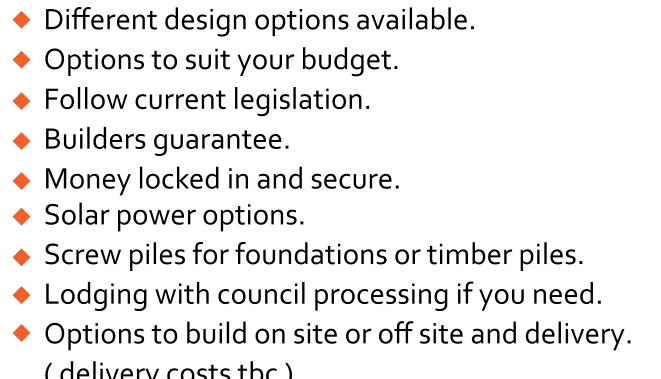

**Get in touch today for a free quote,
no commitments necessary.**



Our fully customizable tiny homes are built specifically to suit your needs, wants & budget.

Whether you're seeking a cozy retreat in the countryside, a versatile backyard studio, air b and b for secondary income or a granny flat for family, our tiny homes offer endless possibilities.

We collaborate closely with each client, ensuring that every aspect of their tiny home aligns seamlessly with their vision and budgetary constraints. With options available for every budget.



Phone: 021 378 277

www.smallbuilds.co.nz

info@smallbuilds.co.nz

Home & Garden

Laser Plumbing & Roofing Whenuapai – your local plumbing, roofing & drainage specialists



Happy New Year! It's hard to believe another year is done and dusted. Welcome to 2026.

The New Year is a great time to start fresh and sort any of those pesky plumbing issues that you may have been putting off. Give us a call and we can help you out.

Maintenance Plumbing – for all your plumbing requirements, from basic tap washers, leaking pipes, the dreaded blocked toilets, or gas work, our maintenance plumbers are here to help.

Drainage – our qualified drainlayers can perform a full range of drainage repairs and replacements through to new drainage jobs – both storm water and wastewater. We offer a state-of-the-art drain unblocking service, CCTV inspection service and a dedicated tip truck and digger to get the drainage work done. We are also Auckland Council certified to carry out septic tank inspections and maintenance.

Roofing – We find and fix roof leaks. We also offer all roofing services...from repairs and gutter cleans right through to full re-roofs.



● PLUMBING	● DRAINAGE	● ROOFING
Renovations Waste Disposal Leaking Taps High Water Bill Hot Water Cylinder Back Flow Prevention New House Plumbing Burst Pipes Maintenance & MORE	Septic Tank Council Inspections (Auckland Council Approved) Septic Tank New Installations Septic Tank Repairs New Drainage Drain Repairs / Replacements Drain Unblocking Stormwater / Sewer Systems Cesspit Installation / Repairs & MORE	Long Run Roofing Downpipes Flashing Work New Roofs Roof Repairs Roof Maintenance Gutter Replacements Gutter Repairs

09 417 0110

whenuapai@laserplumbing.co.nz

Laser Whenuapai has been trading since 1985 – so choosing us means choosing a solid, reliable, and experienced company that you can depend on. Not only can we offer you total solutions for all your plumbing, drainage, or roofing needs, we stand by all our jobs by offering warranties...and always use quality New Zealand made products.

Get in touch with us today on 09-417-0110 or whenupai@laserplumbing.co.nz.

ANYTIME PEST CONTROL

FLIES, ANTS, COCKROACHES, FLEAS

RATS, MICE, SPIDERS, WASPS ETC.

WEEDSPRAYING

KEVIN MORRIS REGISTERED TECHNICIAN

PHONE: 09 411 7400 MOBILE: 027 277 7143



Grant Castle



P (09) 412 8239 | 23 Wookey Lane, Kumeu
M 027 299 7054 | E castlepanelbeating@orcon.net.nz



SERVICE CENTRE

EOIN STUART

Phone 09 412 5900 | Mob 022 639 0274
338 Main Road Huapai - Kumeu, Auckland 0810
autoworxnz@outlook.com

Your Trusted Local Electricians



Meet Our Team

Based in Waimauku, Auckland, we want to be the number one choice for local electrical services and pride ourselves on exceeding clients' expectations.

Our team is highly experienced in delivering cost-effective, high-quality workmanship. Our relationship with our clients begins on the first day of contact and ends once they're fully satisfied with our work.

Andrew Shone builder

Services offered since 1990

Repairs, Renovations, Maintenance, Installation, Framing, Appraisals, Building, Construction Services, Carpentry

Expertised in Builders

Repairs, Renovations, Maintenance, Installation, Framing, Appraisals, Alterations

we are providing services in Kumeu

Andrew Shone.

Carpentry & Building Services.

Small alterations , Fencing , Decking & General Building repairs.

Free quotes

Ph 021 999 542 or 412 6213

Email shonebuilder@xtra.co.nz

BLACKOUT ELECTRIC LTD

022 500 5856
info@blackoutelectric.co.nz
www.blackoutelectric.co.nz

Hauraki Gulf is in trouble



The Hauraki Gulf is in trouble, and needs healing. This beautiful body of water is rich in diverse eco-systems. However, it is facing a slow death.

With the enormous increase in Auckland's population over the past century, vast land clearing has occurred for building houses and roads, and millions of tons of soil have washed into the Gulf resulting in sedimentation polluting the waters. This chokes and smothers life in the Gulf, reducing light levels and limiting the ability for marine creatures to find their food.

Where plants have been removed from the soil, the soil becomes unstable. Kaipātiki Project in North Auckland is a not-for-profit environmental organisation growing a sustainable future for people and nature. Their thriving plant nursery enables volunteers to raise many thousands of chemical-free native plants to be used to restore the health and vitality of the Hauraki Gulf. Community planting days trap the sediment in place to improve the biodiversity of the available land. Planting native shrubs and trees also provides food for native fauna. Collapsing ecosystems need balanced biodiversity to recover. Planting is just a start, and the plants have to be looked after.

In addition, the Hauraki Gulf is home to a treasure trove of marine life, but fishing practices have harmed the habitat of the Gulf, and have completely altered the sea floor. Practices include commercial and recreational fishing and bottom trawling, all of which contribute to an imbalance of species and large reductions in numbers. The Hauraki Gulf is also a seabird sanctuary of international significance. Heal the Hauraki was formally launched last year with a docu-series and media campaign (healthauraki.com) and seeks to bring communities together and help the Gulf thrive again, aligning with science and traditional Maori cultural knowledge.

Image from the Heal the Hauraki videos.

STIHL SHOP KUMEU

Cub Cadet HUSLER ROVER WALKER

54 Main Rd
Kumeu
PH: 412 8592
OPEN MON-SAT

YOUR RIDE ON MOWER EXPERTS



Young Learners

Growing together: Simple ways to spark curiosity with your children this season

Across our community, gardens are bursting with new life – and there is no better time to get children outdoors, exploring, planting, and discovering. At Gumboots, our tamariki have been deeply engaged in hands-on gardening experiences through our Garden to Table programme. Their enthusiasm has reminded us just how powerful simple, everyday interactions with nature can be for young children.

You don't need a large garden to get started. Even a small

pot, some seeds, and a patch of sunshine is a world of learning.

Start with simple seeds

Children love watching something they planted themselves begin to grow. At Gumboots, we've set up small greenhouses so tamariki can check on their seedlings each day. You can do the same at home by planting peas, beans, herbs, or even edible flowers in a pot on the deck. Let your child be the one to water, check, and care for the plant – it builds responsibility, patience, and pride.

Explore the magic under the soil

One of the most exciting parts of gardening for our children has been discovering the role of worms. After setting up our worm farm, the children helped introduce a new batch of tiger worms and learnt how these tiny invertebrates help keep our soil healthy.

Gumboots Early Learning Centre

Great outdoor playgrounds

100% Qualified teacher ratios

Music Lessons in the Sun

Now enrolling: Babies for April onwards
Don't miss out!
Call us to visit and meet the team

Open 7am - 6pm - choose your own hours
Just minutes from Helensville / Waimauku / Kumeu
1157 Peak Rd The centre of everywhere Ph: 471 9038

Young Learners

You can recreate this curiosity by lifting up a log, exploring compost, or even starting a simple worm farm at home. Children quickly learn that every creature has a job, and caring for the environment starts with understanding these small but mighty helpers.

Grow something you can eat

There is nothing quite like watching a child pick their own vegetables and proudly present them to the kitchen. Our children have planted a wide range of kai – from zucchinis and cucumbers to spinach, corn, beetroot, potatoes, and pumpkins. When children help grow food, they're far more willing to taste it, cook with it, and talk about where food comes from.

Families can try this at home by choosing one seasonal vegetable to plant and cook together. A simple stir-fry, salad, or smoothie becomes so much more meaningful when children have nurtured the ingredients themselves.

A community challenge: The great pumpkin grow

This year, every child at Gumboots has taken home their own pumpkin seedling to care for – all in preparation for our big community event, the Gumboots Country Fair on 14 February 2026. We'd love to see our wider community



join in too. Anyone can grow a pumpkin, whether in a garden bed, a large pot, or even a grow bag.

Let's keep growing memories

Gardening with children doesn't need to be complicated. It's about slowing down, noticing the small things, and learning alongside them. Whether you're planting your first seed or tending a thriving veggie patch, these shared moments create memories that last long after the harvest.

Meet your everyday heroes



Saturday 14 February 2026
10am-2pm, NorthWest Shopping Centre, Town Square, Maki Street

Enjoy a fun-filled day in the sunshine at NorthWest Shopping Centre to celebrate the everyday heroes who keep our community safe. Head to the NorthWest Town Square and meet the teams from New Zealand Police, the New Zealand Defence Force, St John, Fire and Emergency New Zealand, Surf Life Saving and Coastguard New Zealand. Climb aboard real emergency vehicles, meet the heroes behind the uniforms and keep the kids entertained with free face-painting and balloons. A must-see day out for the whole family.

Free movies in the Square

Movie night is coming to the giant outdoor screen in NorthWest Town Square. Grab the family, cosy up with a blanket and settle in for a night to remember. The Centre closes at 6pm, but Maki Street restaurants will be open late for all your pre-movie eats.

Inside Out 2

Friday 20 February 2026, starts at 6:30pm

Teenager Riley's mind headquarters is undergoing a sudden demolition to make room for something entirely unexpected: New Emotions! Joy, Sadness, Anger, Fear and Disgust, who've long been running a successful operation by all accounts, aren't sure how to feel when Anxiety shows up. And it looks like she's not alone. Rated PG.

The Minecraft Movie

Friday 27 February, starts at 6:30pm

Four misfits find themselves struggling with ordinary problems when they are suddenly pulled through a mysterious portal into the Overworld: a bizarre, cubic wonderland that thrives on imagination. To get back home, they'll have to master this world while embarking on a magical quest with an unexpected, expert crafter, Steve. Rated PG.



Aged care

A new year at Craigweil House

As the new year begins, Craigweil House continues to focus on what matters most – providing a calm, caring, and supportive home for our residents. While the festive season brought joyful Christmas celebrations shared by residents, families, and staff, the start of the year is a time to settle back into familiar routines and everyday comforts.

Our dedicated team remains committed to delivering quality rest home and hospital level care, with kindness, respect, and genuine connection at the heart of everything we do. From friendly conversations to attentive daily support, Craigweil House is a place where residents are known, valued and cared for.

We welcome families to visit and see how we support residents to feel safe, comfortable, and at home throughout the year. PH 094208277

COME VISIT US!
WE ARE LOCATED NEXT TO PARAKAI SPRINGS

Discover a warm and caring home, nestled within the Kaipara Coast and Parakai's geothermal waters.

Rest Home • Hospital • Day Stays

Craigweil House
Home & Hospital
FEEL AT HOME WITH FAMILY

HENRIKWEST
CARE GROUP

09 420 8277 | 143 Parkhurst Rd, Parakai | info@craigweilhouse.co.nz



SeniorNet Kumeu



We had our AGM in November and it all went well with a new member voted on to our committee. In December we had our Christmas meeting which attracted a lot of our members and one new member. Next year will be the same as before with meetings once a month in which we will inform our members of the technical innovations and also articles on new trends. We will continue our very popular courses where we try to run twice a month. In November we ran two courses one on mobile phones and the other on Google maps how to use them on and off line. Our club has had a very successful year and has grown in numbers and hope the trend will continue. If you would like to see what we are about no matter your skill level please come and meet us for a free meeting which we have on the first Wednesday of the month at 10 am in St Chads Church hall 7 Matua Road, Huapai excluding January. We hope to see you then.

Grey Power urges extreme caution for seniors attending major sporting events after assault outside Auckland Stadium



Grey Power is urging older New Zealanders to take extreme care when attending major sporting events this summer, following a disturbing incident in which one of its members was harassed and assaulted outside an Auckland stadium.

The member, a 62-year old football supporter, was leaving Western Springs Stadium recently when he was followed by four young men who subjected him to a prolonged barrage of verbal abuse, including misogynistic and homophobic slurs, and attempted to provoke a physical confrontation. "This was not harmless rowdiness," says Grey Power President Gayle Chambers. "It was targeted intimidation. No one should feel unsafe simply for attending a sporting event."

Despite the seriousness of the incident, the victim was advised that police do not have the resources to investigate the matter to pursue the offenders. Grey Power says this raises wider concerns about public safety around stadiums, particularly during the busy summer events period and on high-risk days involving heavy alcohol consumption.

"We're advising our members to take extreme care when attending large sporting events," Chambers says. "Please ensure you are well supported, travel in a group where possible, and avoid isolated areas when leaving a venue. What happened to our member reflects a broader cultural problem".

Grey Power is calling for:

- Stronger, visible security and policing outside major stadiums;
- Improved crowd-management planning on high-risk weekends;
- A national conversation about alcohol-fuelled aggression and the social norms that enable it.

"Respect should not end at the stadium gate," Chambers says. "Older New Zealanders deserve to enjoy public events without fear. No one – and certainly no senior – should be left vulnerable because a small group decides that humiliation is a sport."

Tom Hendriks



For Summerset at Monterey Park resident Tom Hendriks, his life in New Zealand is as far removed in experience as it is in distance from his childhood growing up in wartime Europe. As a teen, Tom lived in Nazi-occupied Holland, taking part in the perilous work passing messages to the Dutch Resistance. Tom's

youth meant he was spared from frontline duty, and the Germans didn't think twice about a boy on a bicycle. "My parents never even knew of my involvement 'til many, many years after the war."

Although Tom's wife, Else, was only six when war broke out, she vividly recalls hiding in a bedroom as bombs dropped close by. The occupying Germans ordered every family to turn in their radios to keep them ignorant of what was happening on the Front. "My father had two radios," says Else. "He turned in one, and then kept the other, hidden inside a false wall and would listen to the BBC World Service." Her father was betrayed by a neighbour, and German soldiers raided the house. "My father had just enough warning to hide inside the cavity with the radio." Once the war was over, my mother was desperate to leave Holland. "We had been billeting a Major from the New Zealand Army, who talked about New Zealand and my mother decided that it would become our home. We sailed to Sydney then flew to Whenuapai"

Just a few short months later, Tom, who had been serving in the Dutch army in Indonesia also arrived at Whenuapai. "I saw a photo of New Zealand and thought it looked like paradise."

The couple, who have been married for 73 years, met in an Auckland cafeteria run for ex Dutch servicemen. The

pair settled in West Auckland, where Tom moved into real estate and Else raised the family.

This story is adapted with permission from a feature first published in Summerset Scene magazine, issue 33, <https://www.summerset.co.nz/about-us/summerset-scene/>

Kiwi Rehab



Kia ora te Tau Hou - Cheers to the new year!

We hope you had a safe and relaxing Christmas and New Years - or maybe you had a few too many at new years... not to fear! Whether you broke yourself, broke your equipment, it's time for an upgrade or you've been putting off that

service, our team are here to help!

Our dedicated team are able to offer expert servicing and repairs to keep you moving - whether it's a flat tyre on your wheelchair, a broken scooter headlight, or a bit of routine maintenance, our team will get you back up and running quickly and safely. Our books are filling up fast so make sure you contact us and book in today.

Maybe you got a bit wild over the break and need a new set of wheels? We have a vast range of scooters, wheel chairs, lift out chairs, walkers, walking sticks and more that are available to hire or purchase to get you back up and running in no time! Want a bit extra? we also have a wide range of pressure relieving cushions and aids for daily living.

Discover how we can help you live more comfortably and independently.

Visit our website or contact our friendly team today - because at Kiwi Rehabilitation, people always come first.

www.kiwirehab.co.nz

027 244 2443

sales@kiwirehab.co.nz

www.kiwirehab.co.nz
027 244 2443
sales@kiwirehab.co.nz



He Tangata, He People
KIWI REHABILITATION LTD.



Health & Beauty

Treating benign skin lesions with precision and care



Many people live with small skin lesions such as benign moles or visible red vessels (telangiectasia) that, while harmless, can be bothersome. You may have even been told that the only way to treat these is with surgery requiring stitches, and resulting in a scar. However modern radiofrequency based surgical technology allows these concerns to be treated with precision and minimal disruption to surrounding skin.

At Restore Cosmed, we use Surgitron radiofrequency, a sophisticated technique that uses high-frequency radio waves to remove selected benign lesions under local anaesthetic. The treatment is quick, controlled, and typically involves little to no bleeding, no stitches, and a low risk of scarring.

Surgitron can be used for carefully selected benign skin lesions, skin tags, and small telangiectasia, particularly in areas where precision matters and the best cosmetic outcome is required.

Even lesions that appear benign, should not be treated without expert assessment. Every lesion we treat is first assessed by a clinician trained in dermoscopy. If there is any concern about a lesion's nature, alternative

management including surgical removal and pathology may be recommended.

Removal of some lesions may even be covered by your health insurance.

Dr Cherie Wyatt-Hutana Restore Cosmed – Doctor-Led Cosmetic & Skin Clinic, Huapai

Glow into 2026: skincare trends you need to know



The new year is the perfect time to refresh your skincare routine. Experts are predicting 2026 will be all about combining science and simplicity for healthier, radiant skin.

One of the biggest trends is personalised skincare. With technology like AI skin analysis and 3D imaging, treatments and products can now be tailored to your exact skin type, concerns and lifestyle. This

isn't just for celebrities – clinics and beauty brands are making it more accessible than ever.

Sustainable beauty continues to grow, with eco-friendly packaging, refillable products, and cruelty-free formulations becoming a standard expectation rather than a luxury. Choosing products that are good for your skin and the planet has never been easier.

Another hot trend is skin health from within. Nutrition, hydration, and supplements are increasingly recognised as vital to achieving a natural glow. Collagen, antioxidants, and omega-rich diets support skin elasticity and overall radiance.

Finally, stress-free self-care is key. Regular facials, gentle massages and mindful routines aren't just pampering—they improve circulation, reduce inflammation and leave skin looking fresh and revitalised.

Whether you're updating your routine or starting from scratch, 2026 is shaping up to be the year of smart, sustainable and glowing skincare.

RESTORE
COSMED
SKIN AND MEDICAL

www.restorecosmed.co.nz
contact@restorecosmed.co.nz

20 Matua Road,
Huapai.

Health & Beauty

Norwest Podiatry making footcare more accessible



The start of a new year is often filled with fresh goals, busy schedules, and plans for what lies ahead. At Norwest Podiatry, we believe that a strong year begins with

strong steps. In 2026, we're making it easier than ever for our local community to prioritise foot health. To improve access to regular foot care, Norwest Podiatry is pleased to announce the opening of a new Satellite Podiatry Clinic at Waitakere i-MEDICAL Centre, WestCity, Henderson. This new location brings professional podiatry services closer to home for West Auckland residents and reflects our ongoing commitment to supporting mobility, comfort, and independence in the community.

The Henderson satellite clinic operates Tuesdays, offering the same trusted care and clinical standards our patients know and value. Our Kumeu clinic will continue operating at its regular hours, including Tuesdays, ensuring patients can choose the location and appointment time that best suits their needs.

Early in the year is an ideal time to focus on foot health. A medical pedicure safely removes callus, rough skin, and nail concerns, helping to reset your baseline and prevent small issues from becoming bigger problems. Looking after the foundation that carries you into every goal, plan, and adventure can make a real difference to how you move and feel day to day.

To celebrate the new year and the opening of our Henderson clinic, Norwest Podiatry is offering a 'Refer a Friend' promotion across both our Kumeu and Henderson clinics. Refer a friend and receive \$20 off your next appointment. This offer is valid for January and February only (T&C's Apply).

At Norwest Podiatry, we're here to help you every step of the way, book today.



NORWEST
PODIATRY



Get \$20 off your next visit
when you refer a friend

027 740 4545/09 412 7740

www.norwestpodiatry.co.nz



New Year, new era: Google's new smart glasses due to launch in 2026



Google's new generation AI-powered smart glasses are on the horizon.

Data from tiny on-board cameras will be processed using groundbreaking AI technology to interpret the images and their relationship to the wearer in ways not previously possible. Designed to look and feel almost like everyday eyewear, these new glasses aim to blend digital assistance seamlessly into daily life. Perhaps you can ask if you locked the door or left the iron on – just wear the glasses, and AI will do the rest.

Whether you find this exciting or scary depends on your point of view. But it also highlights something even more important: great vision. Smart glasses rely on clear, comfortable eyesight to work at their best. It is critical to have the lenses accurately centred over the pupils of your eyes, and to correct any underlying refraction with precision. That's where professional eye care makes all the difference. Whether you're curious about future-ready eyewear or simply want to ensure your eyes are healthy, regular eye exams remain essential.

At For Eyes Optometrists in Kumeu, we're passionate about helping our community see clearly—today and tomorrow. Matthew and Molly Whittington, together with Practice Manager Anna O'Hare, provide comprehensive eye exams, personalised advice, and a wide range of quality frames and lenses to suit every lifestyle. As new technologies such as AI-enabled glasses emerge, we're here to help you understand how they fit with your vision needs and whether they're right for you.

The future of eyewear is smart—but great eye care will always be essential.

Contact For Eyes Optometrists on 09 412 8172 or call into the Kumeu Shopping Village 9-5 weekdays.



FOR EYES
OPTOMETRISTS
EST 1993

- Advanced scanning equipment for early detection of cataract, glaucoma and macular degeneration
- Speciality assessment of child and adult reading difficulties
- Specific-tint lenses for Irlen Syndrome
- Lenses to correct red-green colour blindness

90B Main Road, Kumeu Shopping Village

www.foreyes.co.nz foreyes@foreyes.nz 09 412 8172

Hear 4U Ltd



“Start the year hearing clearly: At home help for your hearing aids”

February is a great time for a fresh start—and that includes your hearing.

For many people, hearing aids don’t stop working because they’re old... they simply need a proper clean, a tune-up, or a small adjustment to get them performing at their best again.

That’s where mobile audiologist Lisa from Hear 4U can help.

By visiting clients in their own homes, Lisa can see exactly how hearing aids are performing in real-life situations—whether it’s the TV volume creeping up, difficulty hearing phone calls, or trouble following conversations around the table. Often, a quick clean, a new filter, or a simple setting change is all it takes to restore clarity.

With over 25 years of experience, Lisa provides:

- Hearing aid cleaning, maintenance, and troubleshooting
- Hearing tests and personalised support
- New hearing aids
- Gentle ear wax removal
- Help with TVs, phones, and everyday listening challenges

All delivered in the comfort of your home, across West and Northwest Auckland

If your hearing aids aren’t sounding as clear as they used to—or if you’re ready to start the year hearing well again—Lisa is here to help.

Friendly, professional hearing care at home.

Contact Lisa on 021 209 2687, or email: lisa@hear4u.co.nz



AUDIOLOGY AT YOUR PLACE
PERSONALISED HEARING CARE AT HOME



NEW HEARING AIDS
HELP WITH HEARING AIDS
HEARING ASSESSMENTS
EAR WAX REMOVAL

“Lisa is an Ear Angel. The 95 year old in our lives is happy hearing our conversations and the TV. This means better quality of life when you can’t get out”

www.hear4u.nz 0800 119 510 021 2092687

Ask Dr. Heather



Is Botox® used for helping migraine headaches the same as the Botox® used for lines and wrinkles?

Anon, Kumeu

Yes, it is the same medicine. The difference lies in how it is used, where it is placed and what the treatment is trying to achieve. In cosmetic treatments, Botox® is injected into specific facial muscles that create lines. The focus is on softening lines, while keeping your natural expression.

Migraine treatment is completely different. The goal is not cosmetic. Botox® is used to interrupt muscle and nerve activity that contributes to migraine attacks, leading to a decrease in severity and/or frequency of headaches. The injections are tailored to areas of pain and can include the face, temples, back of the head, neck and shoulders.

The beauty of Botox® for migraines is that it also achieves wonderful cosmetic results when used correctly on facial muscles. Looking and feeling good? Yes please! A common concern however, is whether migraine Botox® will “freeze” the face. When the procedure is performed correctly, it usually doesn’t, so it is important to see an injector who understands facial anatomy so you achieve good functional and cosmetic results.

If you are considering this treatment, start with a conversation with your GP and/or Neurologist to see whether it fits into your migraine plan to ensure it is safe for you and that other causes of migraines have been excluded. Results are often very effective with huge improvements in pain and function, which many describe as life-changing.

Dr. Heather Anderson is a Cosmetic Medicine and Emergency Doctor who practises in her own clinic at ALLOR Cosmetic Medicine in Whenuapai and features in the All or Nothing Podcast (available on Spotify, Youtube and iHeartRadio). If you have a question for Dr. Heather you would like answered anonymously, please email askdrheather@allor.co.nz



ALLOR

COSMETIC MEDICINE

Dr. Heather Anderson
72 Waimarie Rd, Whenuapai
M: 0222626762
www.allor.co.nz

Area Columnists

Riverhead Physiotherapy & Pilates



With the kids heading back to school and routines starting to settle, February is the perfect time to refocus on your own wellbeing. If you’ve been thinking about trying something new, or returning to a movement practice that makes you feel strong and supported - Reformer Pilates could be just what you need.

At Riverhead Physiotherapy & Pilates, our boutique studio offers small, personalised Reformer Pilates classes designed to help you build strength, improve posture, and move with confidence. Whether you’re a complete beginner or returning after time away, our experienced instructors will meet you where you’re at and guide you safely forward.

We offer over 20 classes per week, including early morning, daytime, and evening options to suit your schedule. With just four reformer beds per class, you’ll receive individualised attention in a calm, welcoming space. We also offer one-on-one sessions for those wanting extra support or rehabilitation-focused movement.

Reformer Pilates is low-impact but highly effective, ideal for building core strength, improving flexibility, and supporting injury recovery or prevention. It’s a great way to reset after the summer and lay the foundation for a strong, balanced year ahead.

So, whether you’re picking it back up or giving it a go for the first time, now’s a great time to start.

To learn more or book your first class, visit us online, call/text 027 313 6036, or email pilates@riverheadphysio.co.nz. We’d love to welcome you into the studio.



- REFORMER PILATES STUDIO
- MASSAGE THERAPY & LYMPHATIC DRAINAGE
- ACUPUNCTURE / DRY NEEDLING
- ACC ACCREDITED PROVIDER
- PRE/POST SURGICAL REHAB
- SPORTS INJURIES

 0273136036

 1058 Coatesville-Riverhead Hwy

 physio@riverheadphysio.co.nz

 www.riverheadphysio.co.nz



Mindbody app
for pilates

Sayers Says it



By Rodney Councillor Greg Sayers. With the new Auckland Council term now underway, I want to sincerely thank Rodney residents for the trust you have placed in me. It is an honour to represent our community, and I remain focused on the issues that matter most: fighting rate increases, stopping wasteful spending, returning Council to its core responsibilities, and ensuring more of our rates are invested back into Rodney.

We have made progress in securing a greater share of local rates to be spent locally, but the imbalance is still clear. Too much funding continues to flow into the central. Fixing this remains one of my top priorities.

In a challenging economic environment, Council must show restraint. However, Auckland Council has already signalled an average residential rates increase of 7.9% next year, driven largely by the opening of the City Rail Link (CRL).

- 2.0% to cover inflation for existing asset and services
- 1.5% for maintaining the new assets built as Auckland continues to grow
- 4.4% for the CRL’s operating costs

Most Rodney residents will see little benefit from the CRL, yet we are expected to contribute to its operating costs. I am fighting for Rodney to be excluded from this portion of the rates, which will significantly reduce rate increases. The opportunity for the public about this is open from 28 February to 28 March 2026.

Another way to reduce rate pressure is increasing the Uniform Annual General Charge (UAGC). This would lower rates for most Rodney households while increasing them in areas with lower property values. A decision about this is expected next year.

The Mayor has appointed me to several leadership roles that place Rodney at the table for key decisions, including Chair of the powerful Budget & Performance Committee. My door is always open, and I’m readily available to help anyone with Council-related concerns.



Got council issues? ...
Say it to Sayers
Online video, over the phone, or one-on-one bookings available

Greg Sayers - Rodney COUNCILLOR

P: 021 285 9900 | www.gregsayers.co.nz

Te Awaroa Museum calls on the community as Sunday openings come under pressure



Te Awaroa Museum in Helensville is putting out a heartfelt call to the community as volunteer numbers tighten and the future of its monthly Sunday opening hangs in the balance.

For the past year, the museum has proudly opened its doors on the last Sunday of each month, offering families, weekend visitors, and those unable to attend during the week a chance to connect with the district’s rich local history. These Sundays have become a highlight – but behind the scenes, the small volunteer team is stretched thin.

The reality is simple: without more volunteers, Sunday openings may no longer be sustainable.

The museum currently operates Monday to Wednesday, 10:30am-1:30pm, and the last Sunday of each month, 10:30am-1:30pm. While weekday openings will continue, losing Sundays would significantly reduce access for many in the community.

“We’re incredibly proud of what our volunteers have achieved,” says Leigh Bosch, President of Te Awaroa Museum. “But we’ve reached a point where we need more people to step in. Even a few hours a month could be the difference between staying open on Sundays or having to close.”

Volunteering at the museum isn’t limited to front-of-house hosting. There are a wide range of ways to help, including:

- Welcoming visitors and sharing local stories
- Helping identify people and places in historic photographs
- Assisting with digitisation and archival work
- Research and story gathering
- Exhibition set-ups and light maintenance jobs
- Behind-the-scenes support for events and projects

No experience is required, training is provided and roles are flexible to suit different interests and availability.

Te Awaroa Museum has always been powered by community spirit. With a few more helping hands, it can continue to be a place where local history is shared, remembered and enjoyed by all.

Keen to help?

Email info@museum.teawaroa.nz or phone 09 420 7881, or pop in during open hours for a chat.

Kumeu Library

Kumeu Library is a great place to come to try new things and make new friends. We have a range of regular activities for both adults and children – come and join in in 2026.

Activities for Children:

Storytime: Mondays and Saturdays at 10.30am – Stories, songs, rhymes and a fun activity for children aged 3 to 5 years – Storytime happens every week, even during the school holidays.

Homeschool Make: Build: Do: Wednesdays during school terms at 10.30am, starting 4 February – An hour of constructing, creating and fun for children aged 8 to 13.

After-School Make: Build: Do: Thursdays during school terms at 3.30pm for children aged 8 to 13, starting 5 February – What can you achieve in one hour?

Rhymetime: Fridays at 9.30 –10.00am – for pre-schoolers aged 18 months to 3 years. Rhymetime continues through all the school holidays.

Wriggle & Rhyme: Fridays during school terms at 10.30 –11.00am, starting 13 February – active movement for babies 0 to 2 years.

Homeschool Teens: Fridays during school terms at 1.30 – 3.00pm, starting 13 February – a fun, relaxed time for games, quizzes and challenges. For those aged over 13 years.

Activities for Adults:

Brain Charge for Adults: Tuesdays at 2.00pm during school terms, starting 3 February – give your brain a weekly workout to keep it active.

Book Chat: The first Tuesday of every month at 10.30am, starting 3 February – come and chat about the good books you have read lately while enjoying morning tea.

Book Club: 7.00pm on the 4th Thursday of each month, starting 22 January. Join in our lively discussions – every month we read a different author, genre or theme.

There’s always something happening at Kumeu Library – follow us on Facebook (www.facebook.com/kumeulibrary) to keep up-to-date with all our news and events.



Zash Hair



A clear gloss colour at Zash Hair is one of the simplest yet most effective ways to elevate the look and feel of your hair. Designed to enhance your natural colour without adding pigment, a clear gloss is all about shine, health, and long-lasting manageability.

One of the biggest benefits of a clear gloss is the instant boost in shine. The treatment smooths the hair cuticle, allowing light to reflect beautifully for a luminous, glass-like finish. Hair instantly looks healthier, silkier, and more polished–perfect for refreshing dull or tired hair between colour services.

Clear gloss treatments also improve the overall condition of the hair. At Zash Hair, our gloss formulas are carefully selected to nourish and hydrate, helping to reduce frizz, seal in moisture, and improve softness without weighing the hair down. This makes it an ideal option for all hair types, including natural, coloured, or chemically treated hair.

Another key benefit is longevity. A clear gloss helps protect your existing colour by sealing the cuticle, which can slow fading and keep tones looking fresh for longer. For clients who love their current colour but want to maintain that “just coloured” look, a clear gloss is the perfect solution.

Beyond aesthetics, a clear gloss offers a low-commitment, low-maintenance service. There is no regrowth line, no colour change, and minimal upkeep–just healthier, shinier hair.

At Zash Hair, a clear gloss is more than a finishing touch; it’s a treatment that enhances confidence, protects your hair, and keeps it looking its absolute best.

Call or message us today at Zash Hair 021814663

Zash Hair

HAIR BY CARLA

77 Waitakere Road, Waitakere, Auckland

Phone: 021 814 663 zashhair

Why Skin Often Flares After Summer



By Sarah Tumulty - Your Skin Nutritionist

Many people notice skin changes in late summer and early autumn – including breakouts, redness, sensitivity, eczema flares, dehydration, or uneven texture. While skin barrier plays a role, these shifts are often driven by what’s happening internally and environmentally. Heat is a major trigger for skin inflammation. Hot weather increases sweating, blood flow to the skin, and histamine release, which can aggravate eczema, rosacea, itching, and redness. Heat also weakens the skin barrier, making skin more reactive to products, friction, and allergens – particularly behind knees, elbows, necks, and facial folds.

Over summer, digestion can also become disrupted by irregular meals, alcohol, sugar, travel, dehydration, and routine changes. The gut and liver are responsible for processing inflammation and metabolic waste. When these systems are under strain, the skin often becomes the “overflow” organ, showing visible signs of imbalance.

Another key factor is an impaired skin barrier. When the barrier is compromised – often from heat, UV exposure, over-cleansing, exfoliation, or inappropriate products – the skin loses moisture more easily and becomes vulnerable to irritants and microbes. This can worsen eczema, delay healing, and lead to ongoing sensitivity even when using “good” skincare.

At SWAN Skin Wellbeing & Nutrition, February focuses on education and gentle support rather than aggressive treatments or harsh detoxes. Skin health is approached by supporting digestion, skin barrier repair, and internal balance – allowing the skin to calm and rebalance naturally.

Throughout February, SWAN is offering 15% consultation credit on personalised Skin & Wellness Consultations. These sessions help identify the drivers of skin concerns, review current products or supplements, and create a realistic plan to support skin and overall wellbeing as the seasons change. SWAN Skin Wellbeing & Nutrition February only - Limited appointments available

treating the source of your skin concerns

- Skin & Digestive Consultations
- Skin & Nutrition Plan with Guidance
- Advanced Skin Treatment Facials
- Reflexology Facials
- Holistic Skin Mapping
- Hair Testing: Food Sensitivity & Nutrition
- Practitioner Grade Products
- Teen Skin Advice
- Swedish Relaxing Massage

Sarah Tumulty - Your Skin Nutritionist
FUNCTIONAL SKINCARE PRACTITIONER & NUTRITIONIST

KUMEU, AUCKLAND PHONE: 0274473013
WWW.SWANSKINANDNUTRITION.COM

A New Year, the Same Local Commitment – and Even Bigger Plans for 2026



The past year was a big one for MTF Finance Kumeu – and not just in lending. In a challenging economic climate, the team was proud to stand alongside local customers, helping many navigate tougher times with practical, responsible finance solutions and a friendly face when it mattered most.

2025 also brought plenty to celebrate. MTF Finance Kumeu opened the doors to a brand-new office on the Main Road, strengthened ties with the community by supporting school fundraisers, sponsoring the North West Business Awards, and building new partnerships with local businesses. The year wrapped up on a high note with national recognition, taking home the Culture of Responsibility Award at the MTF Franchise Conference – a testament to the team’s values and customer-first approach.

As the new year gets underway, the team is excited to keep helping Kiwis move forward – whether it’s finance for a new home, car, holiday, renovation or business growth. Whatever your plans for the year ahead, MTF Finance Kumeu has lending options to suit.

Pop in for a cuppa and a chat at 49 Main Road, Kumeu, call 09 399 2478, or apply online at mtf.co.nz/kumeu.

WIN \$5,000

Take out a loan before 28 February 2026 and you’ll be in the draw to win \$5,000.

Competition terms and conditions apply. Responsible lending criteria and checks apply. See mtf.co.nz/terms.

Here’s to a brighter year ahead – together.

Your local lending specialists.

New car, new home, new business loan... a new renovation and inspired motivation...

Whatever dream you’re ready to pursue, MTF Kumeu has a loan that’s tailored for you.

Take out a loan before 28 February 2026, and you’re in the draw to win five thousand dollars.

Competition terms and conditions apply. Responsible lending criteria and checks, terms and conditions apply. See mtf.co.nz/terms

Apply online or visit our office at First Floor, 49 Main Road.

mtf.co.nz/kumeu

Responsible lending criteria and checks, terms and conditions apply. See mtf.co.nz/terms

mtf
Your local money experts
KUMEU

Cat lovers we need your help



The NZ Cat Foundation has a sanctuary based in Huapai which houses over 150 cats. We offer safe sanctuary for older, disadvantaged and un-homeable rescue cats where they can live out their lives in safety and comfort. We need regular volunteers to help with routine chores so our cats can enjoy happy, healthy, safe lives. We are looking for volunteers who are mature, have a sense of responsibility, are good team players and dedicated animal lovers. Helping at the sanctuary is a popular way to fulfill community service hours for Duke of Edinburgh, St John’s, Scouts, Guides, church, university, animal sciences studies, etc. We are happy to sign off on your hours and provide any needed verification of your service. We rely heavily on volunteers on a daily basis and desperately need more.

Financial and food donations are also urgently needed to cover vet and other costs associated with our sanctuary. The NZ Cat Foundation also supports community Trap-Neuter-Return programmes and helps feed and care for many cats living in the community. Please visit our website for more information on volunteering and how to donate at www.thenzcatfoundation.org.nz. You can also email – volunteers: volunteer@thenzcatfoundation.org.nz donations: info@thenzcatfoundation.org.nz.

NOR-WEST AND KUMEU GLASS SERVICES

“Specialists in Windscreens & Glazing”

Some of our services include: Residential and Commerical Glass Repairs - Automotive Glass Repairs - Cat/Dog Door Installs - Splashbacks - Mirrors - Picture Frames - Double Glazing - Caravan and Boat Windows - Car and Truck Mirror Repairs - Stonechips

CALL - 09 412 9914 | nwkg@xtra.co.nz
9a Weza Lane, Kumeu, Auckland 0810

Kumeu Arts



This February, Kumeū Arts bursts into life with one of our most loved members’ exhibitions. Our Aotearoa is a vibrant celebration of the landscapes and natural world that make this country so special. Explore an inspiring collection of paintings, photography, ceramics and sculpture, all showcasing the incredible talent of our local artists. Entry to the galleries is always free. Our popular courses and workshops also kick off this month, with something for everyone – painting, clay, life drawing, our much-loved Children’s Art Club, and more. Love live music? Join us on February 14 for a special performance by West Auckland favourites The Nukes, alongside Australian duo Tyrone and Lesley. We also have three versatile workrooms available, ideal for meetings or small events, with flexible and affordable hire options. Discover what’s on at your local arts hub at www.kumeuarts.org

Kumeu Emergency Network: building a safer, stronger community



Emergencies can strike at any time—from sudden storms and floods to power outages and road accidents. In such moments, having accurate information and a strong support network can make all the difference.

That’s exactly what the Kumeu Emergency Network aims to provide for our local community.

Founded by a group of passionate volunteers, the network is dedicated to keeping residents informed, prepared and connected during times of crisis. Through a combination of alerts, updates and practical advice,

the network ensures that everyone—from families to elderly residents—has the information they need to stay safe. “Our mission is simple,” says Andie for the network. “We are passionate about our community. As a network we work together and with our community before, during and after emergencies to help people be safe, calm, and connected.”

The network operates through multiple channels including email, SMS alerts and social media, ensuring residents can access information quickly and reliably. But it’s not just about sending messages; it’s about creating a resilient community where neighbours look out for one another. Volunteers coordinate local response efforts, check in on vulnerable households and help manage resources during critical events.

Participation is open to all Kumeu residents, whether you want to receive alerts or become a volunteer. Signing up is easy and there are opportunities to contribute in ways that suit your availability and skills. From sharing information during a flood to assisting with local events, every helping hand strengthens the network and makes Kumeu safer for everyone.

In a world where unexpected events can happen at any time, the Kumeu Emergency Network is a reminder that safety is a community effort. By staying informed, prepared and connected, residents can face emergencies with confidence, knowing that help and support are never far away.

To join or find out more, email hellokumeuen@gmail.com or visit their Facebook page at facebook.com/kumeuemergencynetwork.

Sign up to flood alerts by texting ‘flood alert’ to 021 922 545”



Maximise your exposure minimise your bill



Kumeu Courier

Circulation 10,000 + digital
Front cover available
Minimum spend \$100 +gst
Digital upgrades available



The Westerly

Circulation 12,500 + digital
Front cover available
Minimum spend \$100 + gst
Digital upgrades available



Property Hub

Circulation 22,500 + digital
Front cover available
Minimum spend \$150 + gst
Digital upgrades available

editorial@kumeucourier.co.nz